

elevata affidabilità - high reliability

PANELLI®

italian excellence since 1906

6" 8" 10"

140 REC - 180 REC | 60Hz
230 REC

**POMPA SOMMERSA
SEMIASSIALE - GHISA
SEMIAXIAL SUBMERSIBLE
PUMP - CAST IRON**



MADE IN ITALY



6" - 8" - 10" REC - 1



6" 8" 10" 140 REC
180 REC | **60Hz**
230 REC

POMPA SOMMERSA SEMIASSIALE - GHISA
SEMIAXIAL SUBMERSIBLE PUMP - CAST IRON

Pompa semiassiale in ghisa: 6", 8" e 10"

6", 8" and 10" cast iron semi-axial pump

Pompe semi-axiale en fonte 6", 8" et 10"

Bomba semi-axial en hierro 6", 8" y 10"

PANELLI®

italian excellence since 1906

Tolleranza alla sabbia 50 g/m³ - sand tolerance 50 g/m³
Tolleranze secondo UNI ISO 9906 livello 3B - Tolerances according to UNI ISO 9906 grade 3B

6" - 8" - 10" REC - 2

elevata affidabilità - high reliability

PANELLI®

italian excellence since 1906

6" 8" 10" 140 REC
180 REC | **60Hz**
230 REC

POMPA SOMMERSA SEMIASSIALE - GHISA
SEMIAXIAL SUBMERSIBLE PUMP - CAST IRON

Girante e diffusore in ghisa

Impeller and diffuser in cast iron

Roue et diffuseur en fonte

Rodete y difusor en hierro

Robustezza ineguagliabile

Heavy Duty construction

Durabilità

Durabilidad

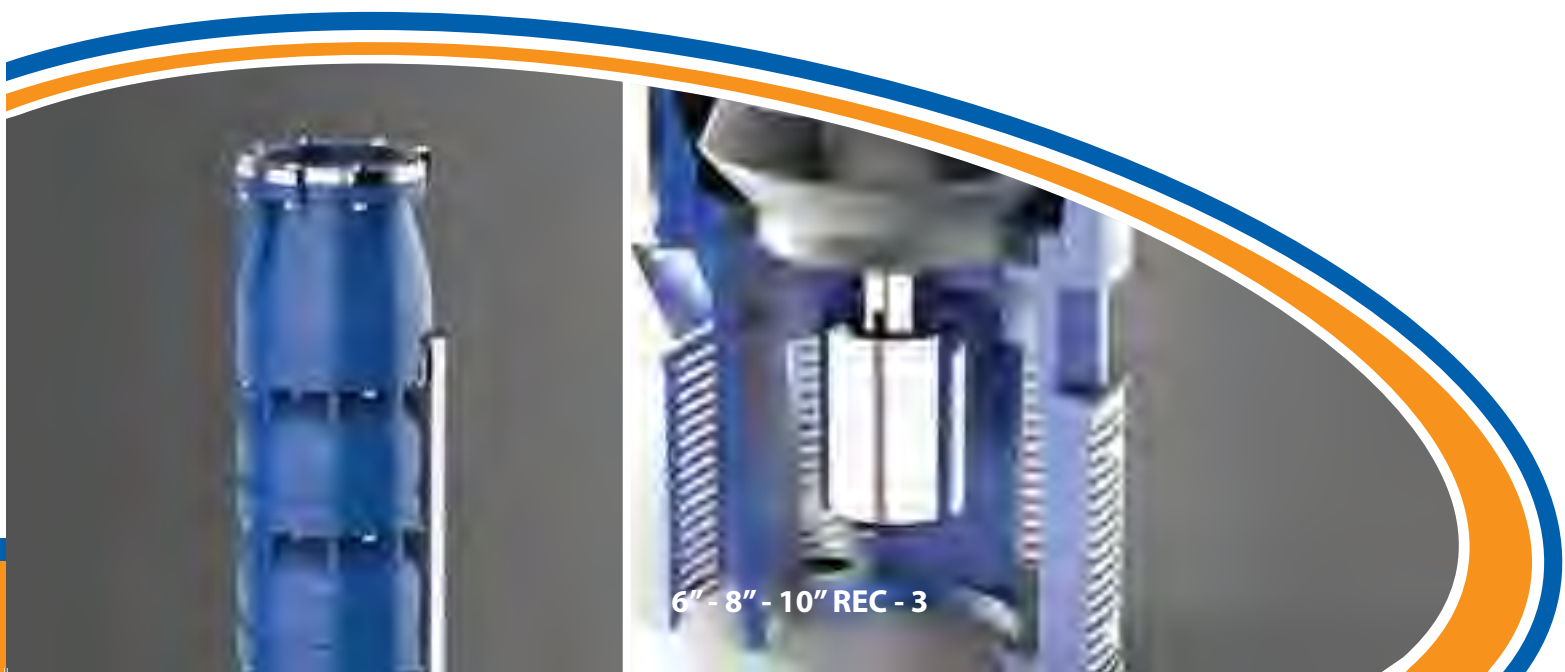

6" - 8" - 10" REC - 3



italian excellence since 1906

6" 8" 10" 140 REC
180 REC | 60Hz
230 REC

POMPA SOMMERSA SEMIASSIALE - GHISA
SEMIAXIAL SUBMERSIBLE PUMP - CAST IRON



ELETTROPOMPE SOMMERSE SEMIASSIALI 6"/8"/10"SERIE 140/180/230 REC, IN GHISA MECCANICA G25

Le pompe sommerse semiassiali sono caratterizzate da stadi formati dal corpo diffusore incorporato e girante semiassiale. Questo tipo di soluzione, rispetto a quella radiale, è ideale quando sono richieste a parità di diametro, medio-alte portate, con medie prevalenze. Adatte a sollevamento di acqua pulita, per approvvigionamento idrico ad uso civile ed industriale, impianti di pressurizzazione, antincendio ed irrigazione, acquedotti.

VANTAGGI

- rendimenti elevati
- facilità di smontaggio
- ridotta manutenzione
- bassi costi di esercizio

MATERIALI

- Girante, diffusore, gabbia di aspirazione e corpo valvola in ghisa meccanica G25 - Albero pompa in acciaio inox Aisi 304
- Anelli di usura, bronzine, guarnizione valvola in gomma NBR
- Anello di contropinta in PTFE+25% GRAFITE

CAMPI DI PRESTAZIONE IDRAULICHE

- Portate fino a 360 m³/h
- Prevalenze fino a 400 metri
- Potenze fino a 300 Kw
- Massima quantità di sabbia ammessa : 50 g/m³
- Massima profondità di immersione : 300 metri.



6"/8"/10"SUBMERSIBLE SEMIAXIAL PUMPS SERIES 140/180/230 REC, IN CAST IRON

The semi-axial pumps impellers with diffusers integrated. These pumps are usually ideal for medium-high capacity and medium head required. PANELLI production offer standard semi-axial pumps from 6" to 10".

ADVANTAGES

Panelli innovative design and the most advanced micro casting technologies allow:

- High efficiency
- Longer life
- Easy assembly/disassembly
- Low maintenance
- Low operating cost

MATERIALS

- Impellers, diffusers, suction cage and delivery bowl in cast iron
- Pump shaft in AISI 304 stainless steel
- Wear rings, bearing buses, valve seal in NBR
- Counter thrust in PTFE+25% GRAFITE

HYDRAULIC PERFORMANCES

- Capacity up to 360 m³/h
- Head up to 400 m
- Power up to 300 kW
- Maximum sand tolerance : 50g/m³
- Maximum depth : 300 metres

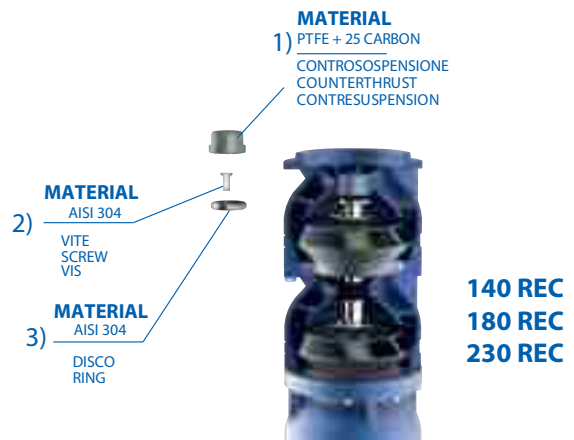

Tolleranza alla sabbia 50 g/m³ - sand tolerance 50 g/m³
Tolleranze secondo UNI ISO 9906 livello 3B - Tolerances according to UNI ISO 9906 grade 3B



italian excellence since 1906

6" 8" 10" 140 REC
180 REC | 60Hz
230 REC

POMPA SOMMERSA SEMIASSIALE - GHISA SEMIAxIAL SUBMERSIBLE PUMP - CAST IRON



POMPES IMMERGÉES SEMIAxIALES 6"/8"/10"SERIE 140/180/230 REC, EN FONTE

Les pompes immergées semiaxiales grâce au design des roues et des diffuseurs peuvent produire des débits moyens élevés et des hauteurs moyennes.

Les pompes sont conçues pour des eaux claires dans toutes applications domestiques, industrielles, systèmes de surpression, groupe incendie, irrigation et réseaux d'eau publiques.

ADVANTAGES

L'innovatif projet Panelli et les technologies de microfusion les plus modernes permettent d'obtenir:

- Très hautes efficacités
- Durée de vie importante
- Facilité de montage et démontage
- Manutention réduite
- Coûts d'exercice réduits

MATERIAUX

- Roues, diffuseurs, cage d'aspiration et refoulement en fonte
- Axe de la pompe en acier inoxydable AISI 304
- Bagues d'usure, bagues, anneau du clapet en caoutchouc NBR
- Contresuspension en PTFE+25% GRAFITE

PERFORMANCES HYDRAULIQUES

- Débit jusqu'à 360 m³/h
- Hauteur jusqu'à 400 m
- Puissance jusqu'à 300 kW
- Tolérance de sable maximum : 50 g/m³
- Profondeur maximum d'immersion: 300 mètres



BOMBAS SUMERGIBLES SEMIAxIALES 6"/8"/10"SERIE 140/180/230 REC, EN HIERRO FUNDIDO

Las bombas sumergibles semiaxiales gracias al design de los impulsores y de los cuerpos se adaptan a caudales medio-elevados y alturas media. Concebidas para el bombeo de aguas limpias en aplicaciones civiles e industriales para el suministro de agua a nivel doméstico, industrial, en grupos de presión, sistemas contra incendio, riego y sistemas de agua pública.

VENTAJAS

El design innovativo Panelli y las tecnologías más modernas garantizan:

- Eficacias elevadas
- Durada de vida muy importante
- Facilidad de montaje y desmontaje - Manutención mínima
- Costos de utilización muy limitados

MATERIALES

- Impulsores, difusores, caja de aspiración e impulsión en hierro fundido
- Eje de bomba en acero inoxidable AISI 304
- Anillos de usura, bocina y anillo válvula en goma NBR.

PRESTACIONES HIDRAULICAS

- Caudales hasta 360 m³/h, Alturas hasta 400 m, Potencia hasta 300 kW
- Cantidad máxima de arena contenida en el agua: 50g/m³
- Sumergencia máxima: 300 metros



Tolleranza alla sabbia 50 g/m³ - sand tolerance 50 g/m³
Tolleranze secondo UNI ISO 9906 livello 3B - Tolerances according to UNI ISO 9906 grade 3B

elevata affidabilità - high reliability

6"

140 REC34

PANELLI®

CARATTERISTICHE IDRAULICHE - HYDRAULIC PERFORMANCES

Q= Portata - Capacity - Debit

60 Hz n= 3450 min

Tipo Type	Power		H(m)	0	360	480	600	720	840	960
	kW	HP		l/min	l/sec	l/sec	l/sec	l/sec	l/sec	l/sec
				m ³ /h	m ³ /h	m ³ /h	m ³ /h	m ³ /h	m ³ /h	
140 REC 34/01	2,2	3	21	0	6	8	10	12	14	16
140 REC 34/02	5,5	7,5	41	0	6	8	10	12	14	16
140 REC 34/03	7,5	10	62	0	21,6	28,8	36	43,2	50,4	57,6
140 REC 34/04	9,2	12,5	82	21	17	16	14	13	11	7
140 REC 34/05	11	15	103	41	35	32	29	26	21	14
140 REC 34/06	13	17,5	123	62	52	48	43	39	32	22
140 REC 34/07	15	20	144	82	69	63	58	53	43	29
140 REC 34/08	18,5	25	165	103	86	79	72	66	53	36
140 REC 34/09	22	30	185	123	104	95	86	79	64	43
140 REC 34/10	22	30	206	144	121	111	101	92	75	50
140 REC 34/11	26	35	226	165	138	127	115	105	86	58
140 REC 34/12	26	35	247	185	156	143	130	118	96	65
140 REC 34/13	30	40	267	206	173	158	144	132	107	72
140 REC 34/14	30	40	288	226	190	174	158	145	118	79
140 REC 34/15	37	50	309	247	207	190	173	158	128	86
140 REC 34/16	37	50	329	267	225	206	187	171	139	94
140 REC 34/17	37	50	350	288	242	222	202	184	150	101
				309	259	238	216	197	160	108
				329	276	253	230	211	171	115
				350	294	269	245	224	182	122

DIMENSIONI D'INGOMBRO E PESI - OVERALL DIMENSIONS AND WEIGHTS

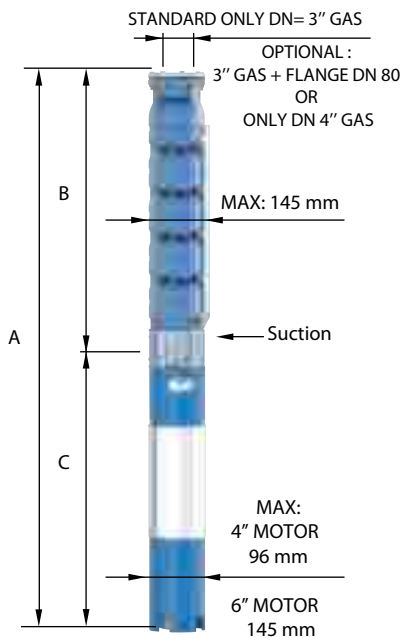

Type	A mm Tri V 460	B mm	C mm Tri	M Kg Tri	P Kg
140 REC 34/01	846	394	452	15	11
140 REC 34/02	1193	495	698	27	15
140 REC 34/03	1297	596	701	55	19
140 REC 34/04	1448	697	751	60	23
140 REC 34/05	1609	798	811	65	28
140 REC 34/06	1740	899	841	70	32
140 REC 34/07	1931	1000	931	75	36
140 REC 34/08	2092	1101	991	83	40
140 REC 34/09	2273	1202	1071	92	44
140 REC 34/10	2374	1303	1071	92	48
140 REC 34/11	2585	1404	1181	100	52
140 REC 34/12	2686	1505	1181	100	56
140 REC 34/13	2857	1606	1251	108	60
140 REC 34/14	2958	1707	1251	108	64
140 REC 34/15	3149	1808	1341	118	69
140 REC 34/16	3250	1909	1341	118	73
140 REC 34/17	3351	2010	1341	118	77

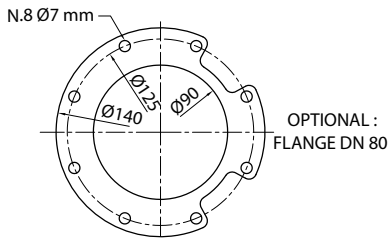

FOR COMMERCIAL TUBE
EXTERNAL DIAMETER: 88,9 mm

n% = Rendimento della pompa
n% = Rendement de la pompe
n% = Pump efficiency
n% = Rendimiento de la bomba

**Max
74%**

kW/st = Assorbimento per stadio
kW/st = Absorption par étage
kW/st = Stage absorption
kW/st = Potencia absorbida por etapa

**Max
2,11**

Tolleranza alla sabbia 50 g/m³ - Sand tolerance 50 g/m³
Tolleranze secondo UNI ISO 9906 livello 3B - Tolerances according to UNI ISO 9906 grade 3B

elevata affidabilità - high reliability

PANELLI®

6"

140 REC34

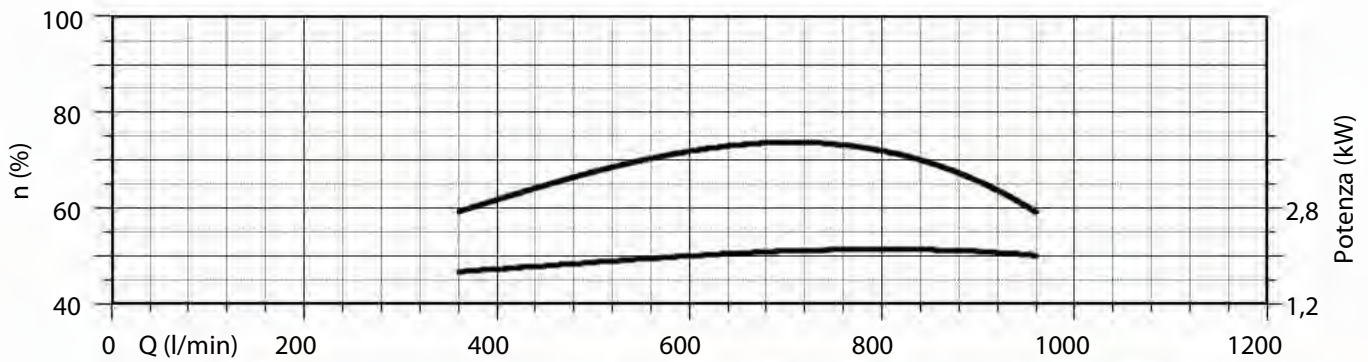
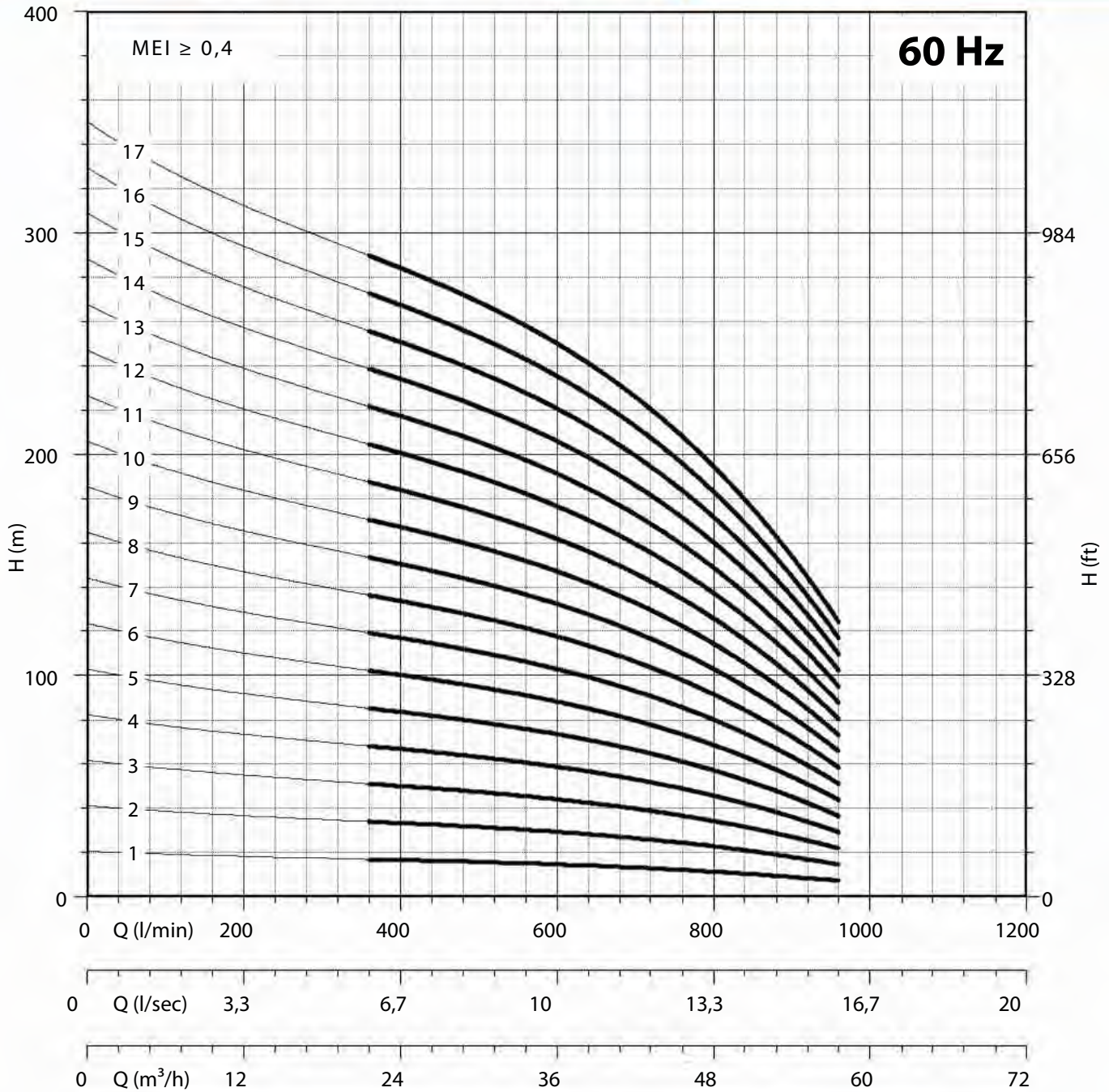

NPSH (m)	25%	50%	75%	100%
140 REC 34	3,4	3,4	3,8	8

6" - 8" - 10" REC - 7

elevata affidabilità - high reliability

6"

140 REC44

PANELLI®

CARATTERISTICHE IDRAULICHE - HYDRAULIC PERFORMANCES

Q= Portata - Capacity - Debit **60 Hz n= 3450 min**

Tipo Type	Power		H(m)	0	480	600	720	840	960	1080	1200	
	kW	HP		l/min	l/sec	m ³ /h	l/min	l/sec	m ³ /h	l/min	l/sec	m ³ /h
				0	8	10	12	14	16	18	20	
140 REC 44/01	2,2	3	19	0	28,8	36	43,2	50,4	57,6	64,8	72	
140 REC 44/02	5,5	7,5	38	19	58	77	96	115	134	154	173	
140 REC 44/03	7,5	10	58	38	86	115	144	173	202	231	260	
140 REC 44/04	9,2	12,5	77	58	115	154	192	231	270	309	348	
140 REC 44/05	13	17,5	96	77	144	192	240	288	336	384	432	
140 REC 44/06	15	20	115	96	173	231	288	345	402	459	516	
140 REC 44/07	18,5	25	134	115	202	270	336	402	468	534	600	
140 REC 44/08	18,5	25	154	134	231	309	384	459	534	609	684	
140 REC 44/09	22	30	173	154	260	348	432	516	600	684	768	
140 REC 44/10	26	35	192	173	288	384	480	576	672	768	864	
140 REC 44/11	26	35	211	192	317	424	528	632	736	840	944	
140 REC 44/12	30	40	230	211	346	464	576	688	800	912	1024	
140 REC 44/13	30	40	250	230	375	504	624	744	864	984	1104	
140 REC 44/14	37	50	269	250	404	544	672	800	928	1056	1184	
140 REC 44/15	37	50	288	269	433	584	720	856	992	1128	1264	
140 REC 44/16	37	50	307	288	462	624	768	912	1056	1200	1344	

DIMENSIONI D'INGOMBRO E PESI - OVERALL DIMENSIONS AND WEIGHTS

Type	A mm Tri V 460	B mm	C mm Tri	M Kg Tri	P Kg
140 REC 44/01	846	394	452	15	11
140 REC 44/02	1193	495	698	27	15
140 REC 44/03	1297	596	701	55	19
140 REC 44/04	1448	697	751	60	23
140 REC 44/05	1639	798	841	70	28
140 REC 44/06	1830	899	931	75	32
140 REC 44/07	1991	1000	991	83	36
140 REC 44/08	2092	1101	991	83	40
140 REC 44/09	2273	1202	1071	92	44
140 REC 44/10	2484	1303	1181	100	48
140 REC 44/11	2585	1404	1181	100	52
140 REC 44/12	2756	1505	1251	108	56
140 REC 44/13	2857	1606	1251	108	60
140 REC 44/14	3048	1707	1341	118	64
140 REC 44/15	3149	1808	1341	118	69
140 REC 44/16	3250	1909	1341	118	73

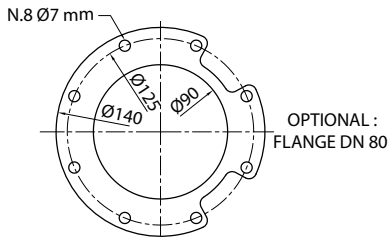
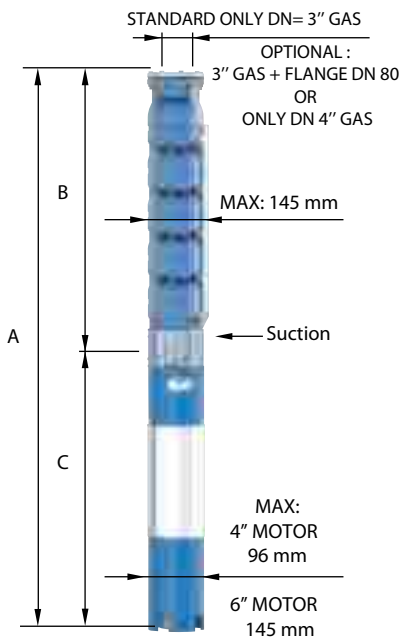

FOR COMMERCIAL TUBE
EXTERNAL DIAMETER: 88,9 mm

n% = Rendimento della pompa
n% = Rendement de la pompe
n% = Pump efficiency
n% = Rendimiento de la bomba

**Max
74%**

kW/st = Assorbimento per stadio
kW/st = Absorption par étage
kW/st = Stage absorption
kW/st = Potencia absorbida por etapa

**Max
2,28**

Tolleranza alla sabbia 50 g/m³ - Sand tolerance 50 g/m³

Tolleranze secondo UNI ISO 9906 livello 3B - Tolerances according to UNI ISO 9906 grade 3B

elevata affidabilità - high reliability

PANELLI®

6"

140 REC44

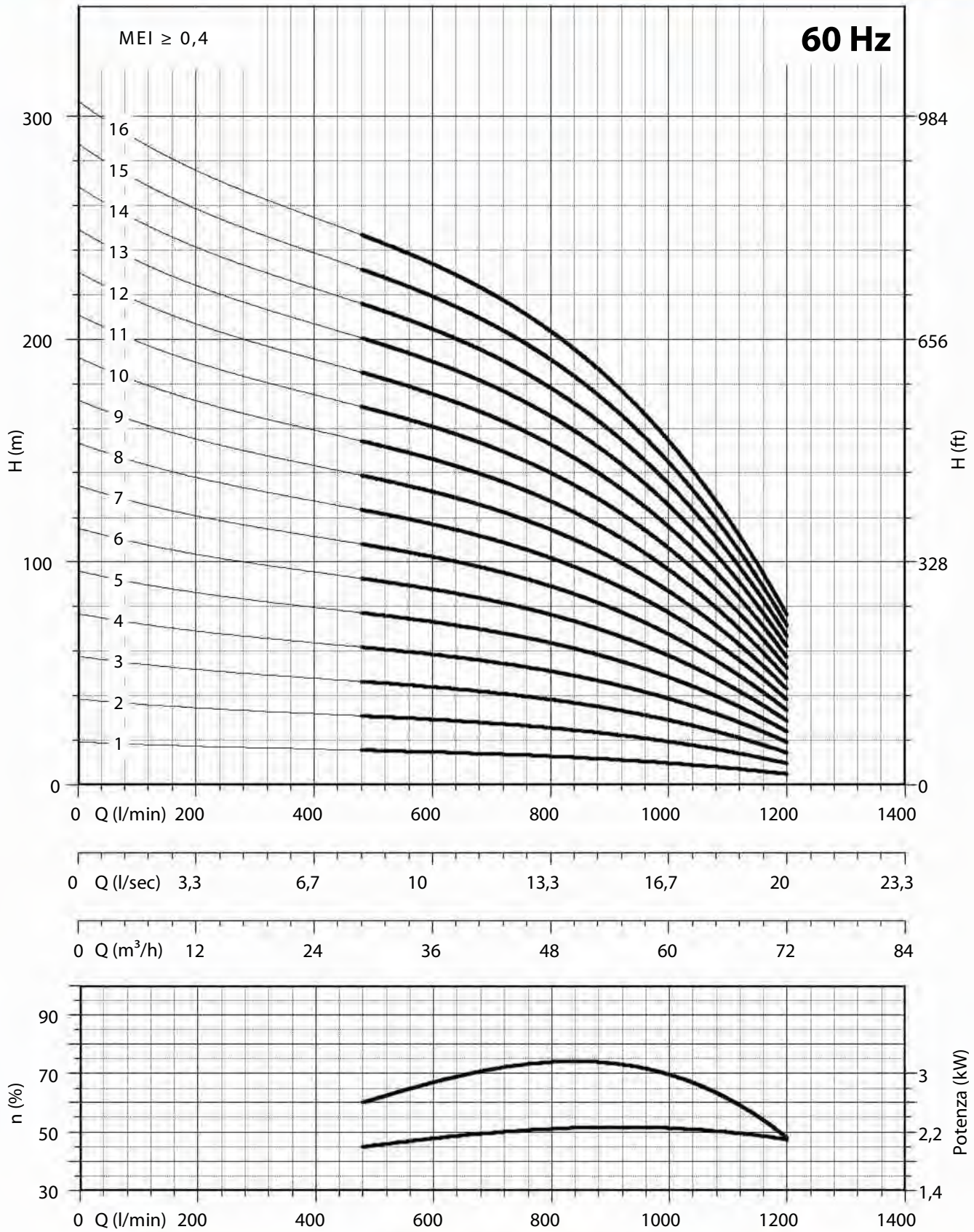

NPSH (m)	25%	50%	75%	100%
140 REC 44	3,45	3,5	3,8	5

6" - 8" - 10" REC - 9

elevata affidabilità - high reliability

6"

140 REC54

PANELLI®

CARATTERISTICHE IDRAULICHE - HYDRAULIC PERFORMANCES

Q= Portata - Capacity - Debit **60 Hz n= 3450 min**

Tipo Type	Power		l/min	0	600	720	960	1200	1440
	kW	HP		l/sec	10	12	16	20	24
				m ³ /h	36	43,2	57,6	72	86,4
140 REC 54/01	3	4	H(m)	19	14,4	13,5	11	8	4
140 REC 54/02	5,5	7,5		37	29	27	23	17	7
140 REC 54/03	7,5	10		56	43	41	34	25	11
140 REC 54/04	11	15		75	58	54	46	34	15
140 REC 54/05	13	17,5		94	72	68	57	42	19
140 REC 54/06	15	20		112	86	81	69	51	22
140 REC 54/07	18,5	25		131	101	95	80	59	26
140 REC 54/08	22	30		150	115	108	92	68	30
140 REC 54/09	26	35		168	130	122	103	76	34
140 REC 54/10	26	35		187	144	135	114	85	37
140 REC 54/11	30	40		206	158	149	126	93	41
140 REC 54/12	30	40		225	173	162	137	102	45
140 REC 54/13	37	50		243	187	176	149	110	49
140 REC 54/14	37	50		262	202	190	160	119	52
140 REC 54/15	37	50		281	216	203	172	127	56

DIMENSIONI D'INGOMBRO E PESI - OVERALL DIMENSIONS AND WEIGHTS

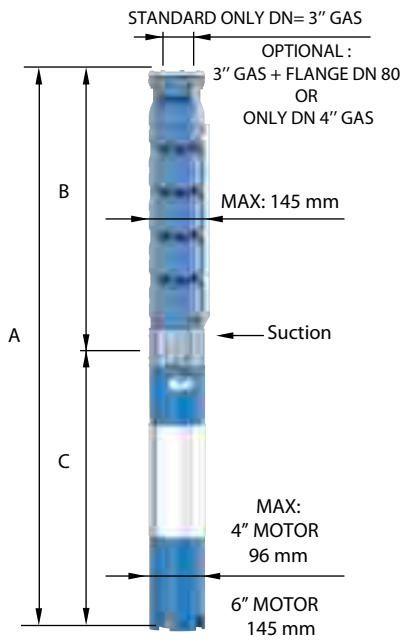

Type	A mm Tri V 460	B mm	C mm Tri	M Kg Tri	P Kg
140 REC 54/01	957	400	557	19	12
140 REC 54/02	1205	507	698	27	16
140 REC 54/03	1315	614	701	55	21
140 REC 54/04	1532	721	811	65	25
140 REC 54/05	1669	828	841	70	30
140 REC 54/06	1866	935	931	75	34
140 REC 54/07	2033	1042	991	83	39
140 REC 54/08	2220	1149	1071	92	43
140 REC 54/09	2437	1256	1181	100	48
140 REC 54/10	2544	1363	1181	100	52
140 REC 54/11	2721	1470	1251	108	57
140 REC 54/12	2828	1577	1251	108	61
140 REC 54/13	3025	1684	1341	118	66
140 REC 54/14	3132	1791	1341	118	70
140 REC 54/15	3239	1898	1341	118	75

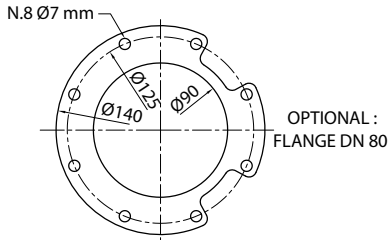

FOR COMMERCIAL TUBE
EXTERNAL DIAMETER: 88,9 mm

n% = Rendimento della pompa
n% = Rendement de la pompe
n% = Pump efficiency
n% = Rendimiento de la bomba

**Max
73,6%**

kW/st = Assorbimento per stadio
kW/st = Absorption par étage
kW/st = Stage absorption
kW/st = Potencia absorbida por etapa

**Max
2,49**

Tolleranza alla sabbia 50 g/m³ - Sand tolerance 50 g/m³
Tolleranze secondo UNI ISO 9906 livello 3B - Tolerances according to UNI ISO 9906 grade 3B

elevata affidabilità - high reliability

PANELLI®

6"

140 REC54

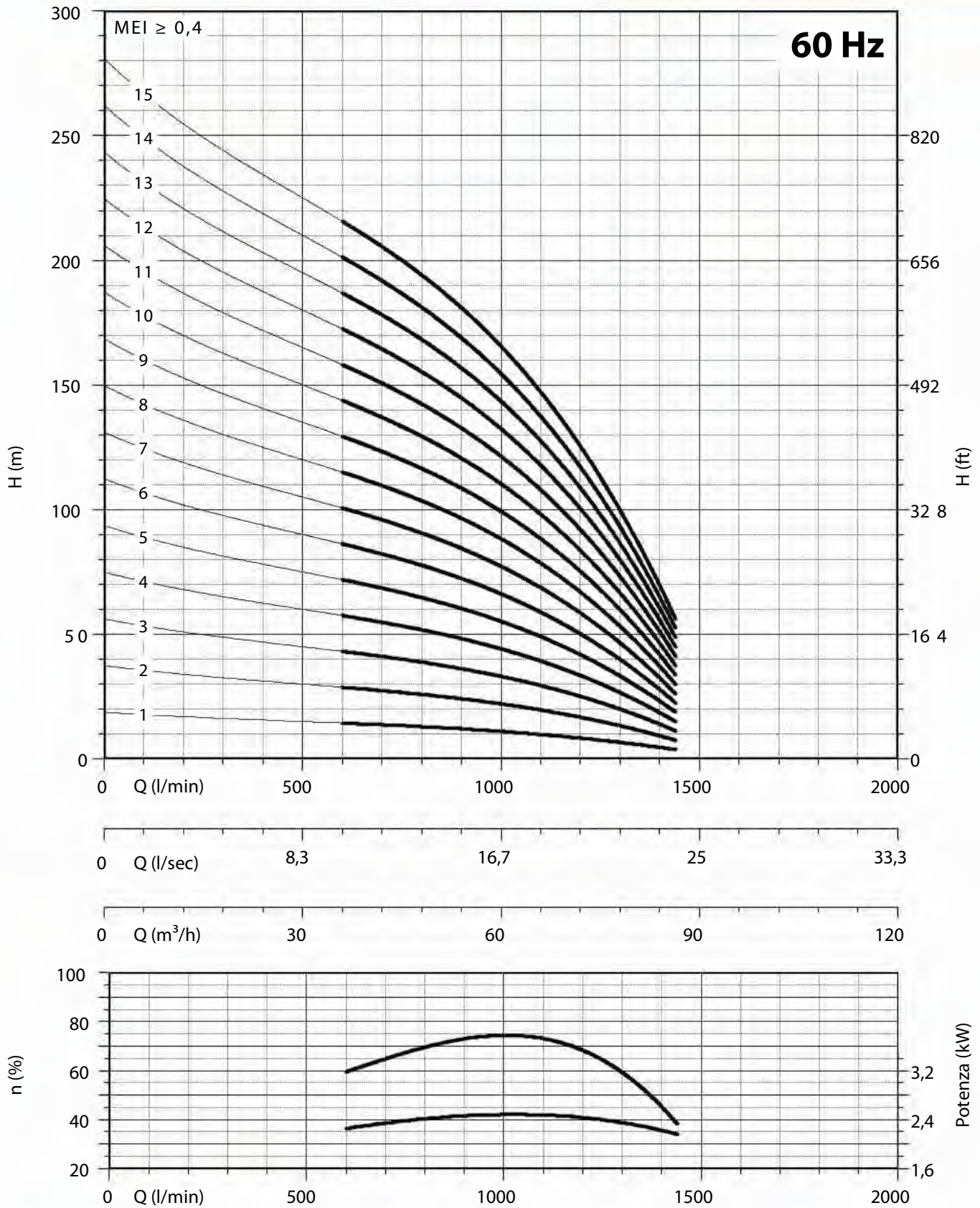

NPSH (m)	25%	50%	75%	100%
140 REC 54	3,8	3,8	5,1	7,1

elevata affidabilità - high reliability

6"

140 REC66

PANELLI®

CARATTERISTICHE IDRAULICHE - HYDRAULIC PERFORMANCES

Q= Portata - Capacity - Debit **60 Hz n= 3450 min**

Tipo Type	Power		H(m)	0	720	960	1200	1440	1680
	kW	HP		l/min	l/sec	l/sec	l/sec	l/sec	l/sec
				m ³ /h	m ³ /h	m ³ /h	m ³ /h	m ³ /h	m ³ /h
140 REC 66/01	3	4	19	14	13	11	8	3	
140 REC 66/02	7,5	10	37	28	25	22	16	6	
140 REC 66/03	9,2	12,5	56	42	38	34	25	9	
140 REC 66/04	13	17,5	75	56	51	45	33	12	
140 REC 66/05	15	20	94	71	63	56	41	14	
140 REC 66/06	18,5	25	112	85	76	67	49	17	
140 REC 66/07	22	30	131	99	89	79	57	20	
140 REC 66/08	26	35	150	113	101	90	66	23	
140 REC 66/09	30	40	168	127	114	101	74	26	
140 REC 66/10	30	40	187	141	127	112	82	29	
140 REC 66/11	37	50	206	155	139	124	90	32	
140 REC 66/12	37	50	225	169	152	135	98	35	

DIMENSIONI D'INGOMBRO E PESI - OVERALL DIMENSIONS AND WEIGHTS

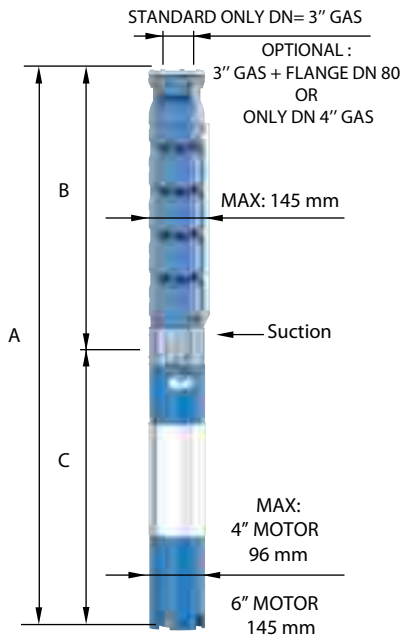

Type	A mm Tri V 460	B mm	C mm Tri	M Kg Tri	P Kg
140 REC 66/01	957	400	557	19	12
140 REC 66/02	1208	507	701	55	16
140 REC 66/03	1365	614	751	60	21
140 REC 66/04	1562	721	841	70	25
140 REC 66/05	1759	828	931	75	30
140 REC 66/06	1926	935	991	83	34
140 REC 66/07	2113	1042	1071	92	39
140 REC 66/08	2330	1149	1181	100	43
140 REC 66/09	2507	1256	1251	108	48
140 REC 66/10	2614	1363	1251	108	52
140 REC 66/11	2811	1470	1341	118	57
140 REC 66/12	2918	1577	1341	118	61

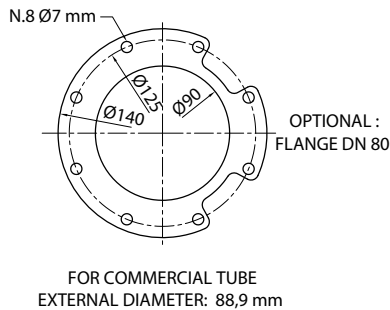

n% = Rendimento della pompa
 n% = Rendement de la pompe
 n% = Pump efficiency
 n% = Rendimiento de la bomba

**Max
74%**

kW/st = Assorbimento per stadio
 kW/st = Absorption par étage
 kW/st = Stage absorption
 kW/st = Potencia absorbida por etapa

**Max
3**

Tolleranza alla sabbia 50 g/m³ - Sand tolerance 50 g/m³
 Tolleranze secondo UNI ISO 9906 livello 3B - Tolerances according to UNI ISO 9906 grade 3B

elevata affidabilità - high reliability

PANELLI®

6"

140 REC66

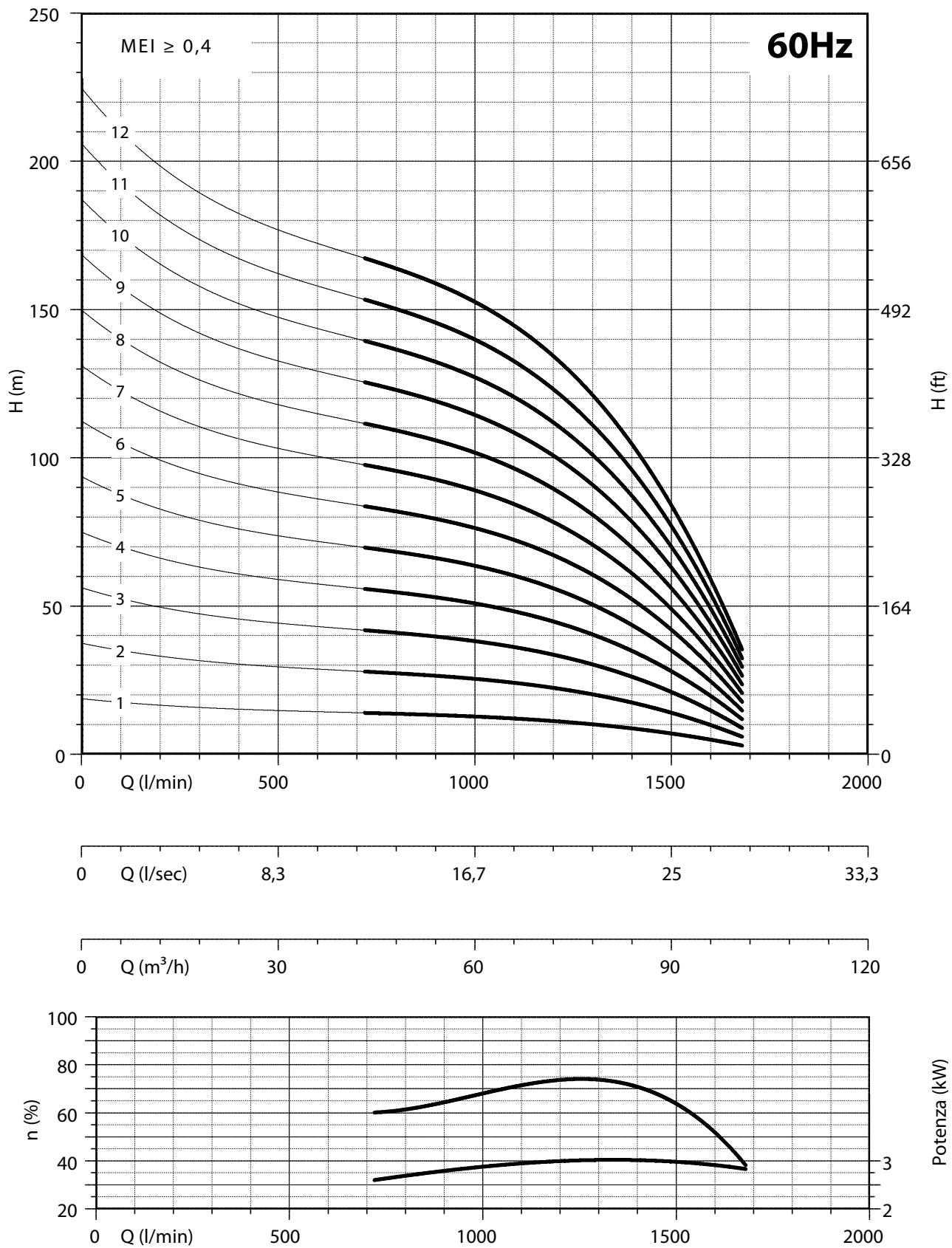

NPSH (m)	25%	50%	75%	100%
140 REC 66	3,8	3,8	5,1	7,1

6" - 8" - 10" REC - 13

elevata affidabilità - high reliability

8"

180 REC78

PANELLI®

CARATTERISTICHE IDRAULICHE - HYDRAULIC PERFORMANCES

Q= Portata - Capacity - Debit **60 Hz n= 3450 min**

Tipo Type	Power		l/min	0	720	960	1200	1440	1680	1920	
	kW	HP		l/sec	0	12	16	20	24	28	32
				m ³ /h	0	43,2	57,6	72	86,4	100,8	115,2
180 REC 78/01	9,2	12,5	H(m)	38	32	30	28	25	21	16	
180 REC 78/02	18,5	25		76	64	60	56	50	42	32	
180 REC 78/03	26	35		113	96	91	84	76	64	49	
180 REC 78/04	37	50		151	128	121	112	101	85	65	
180 REC 78/05	44	60		189	160	151	140	126	106	81	
180 REC 78/06	55	75		227	192	181	167	151	127	97	
180 REC 78/07	66	90		265	224	212	195	176	149	113	
180 REC 78/08	75	100		302	256	242	223	202	170	130	
180 REC 78/09	92	125		340	288	272	251	227	191	146	
180 REC 78/10	92	125		378	320	302	279	252	212	162	
180 REC 78/11	110	150		416	352	333	307	277	234	178	
180 REC 78/12	110	150		454	384	363	335	302	255	194	

DIMENSIONI D'INGOMBRO E PESI - OVERALL DIMENSIONS AND WEIGHTS

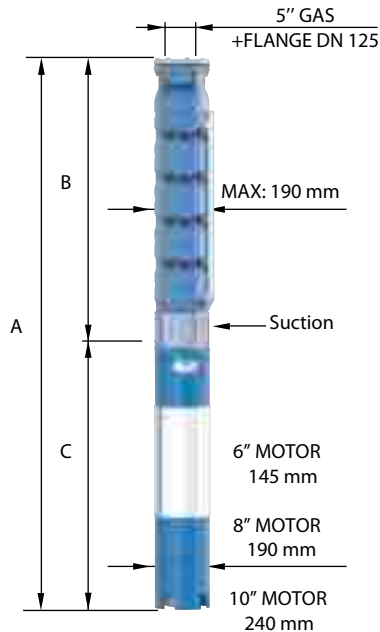

Type	A mm Tri V 460	B mm	C mm Tri	M Kg Tri	P Kg
180 REC 78/01	1278	527	751	60	23
180 REC 78/02	1643	652	991	83	31
180 REC 78/03	1958	777	1181	100	39
180 REC 78/04	2243	902	1341	118	48
180 REC 78/05	2150	1027	1123	178	56
180 REC 78/06	2385	1152	1233	200	64
180 REC 78/07	2580	1277	1303	214	73
180 REC 78/08	2785	1402	1383	230	81
180 REC 78/09	3110	1527	1583	270	89
180 REC 78/10	3235	1652	1583	270	98
180 REC 78/11	3510	1777	1733	300	106
180 REC 78/12	3635	1902	1733	300	114

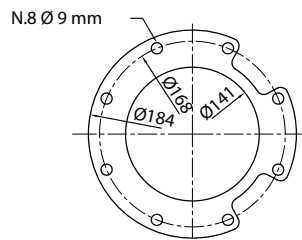

FOR COMMERCIAL TUBE
EXTERNAL DIAMETER: 139,7 mm

n% = Rendimento della pompa
n% = Rendement de la pompe
n% = Pump efficiency
n% = Rendimiento de la bomba

**Max
70%**

kW/st = Assorbimento per stadio
kW/st = Absorption par étage
kW/st = Stage absorption
kW/st = Potencia absorbida por etapa

**Max
8,82**

Tolleranza alla sabbia 50 g/m³ - Sand tolerance 50 g/m³
Tolleranze secondo UNI ISO 9906 livello 3B - Tolerances according to UNI ISO 9906 grade 3B

elevata affidabilità - high reliability

PANELLI®

8"

180 REC78

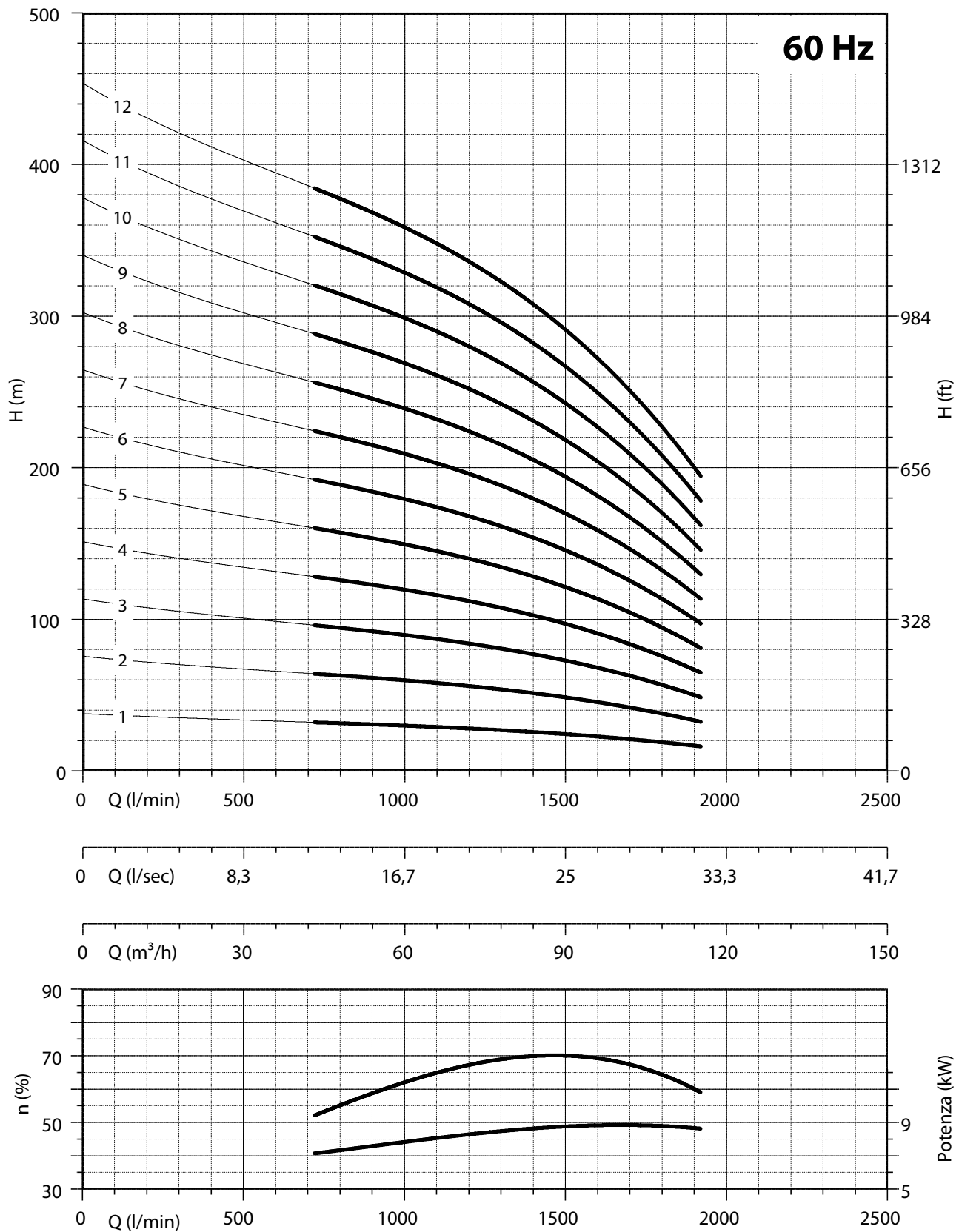

NPSH (m)	25%	50%	75%	100%
180 REC 78	3	3	3,5	4,5

elevata affidabilità - high reliability

8"

180 REC90

PANELLI®

CARATTERISTICHE IDRAULICHE - HYDRAULIC PERFORMANCES

Q= Portata - Capacity - Debit **60 Hz n= 3450 min**

Tipo Type	Power		H(m)	0	960	1200	1440	1680	1920	2160	2400	
	kW	HP		l/min	l/sec	m ³ /h	38	76	113	151	189	227
				0	0	0	38	76	113	151	189	227
180 REC 90/01	11	15		0	16	20	24	28	32	36	40	
180 REC 90/02	22	30		0	57,6	72	86,4	100,8	115,2	129,6	144	
180 REC 90/03	30	40		38	32	30	28	25	22	18	14	
180 REC 90/04	44	60		76	64	60	56	50	44	36	28	
180 REC 90/05	55	75		113	96	90	84	76	66	54	42	
180 REC 90/06	66	90		151	127	120	112	101	88	72	56	
180 REC 90/07	75	100		189	159	150	140	126	110	90	70	
180 REC 90/08	92	125		227	191	180	168	151	132	108	84	
180 REC 90/09	92	125		265	223	210	197	176	154	126	98	
180 REC 90/10	110	150		302	255	240	225	202	176	144	112	
180 REC 90/11	110	150		340	287	271	253	227	198	162	126	
				378	319	301	281	252	220	180	140	
				416	350	331	309	277	242	198	154	

DIMENSIONI D'INGOMBRO E PESI - OVERALL DIMENSIONS AND WEIGHTS

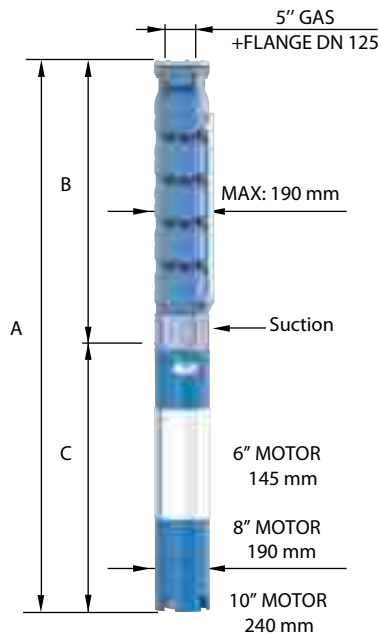

Type	A mm Tri V 460	B mm	C mm Tri	M Kg Tri	P Kg
180 REC 90/01	1338	527	811	65	23
180 REC 90/02	1723	652	1071	92	31
180 REC 90/03	2028	777	1251	108	39
180 REC 90/04	2025	902	1123	178	48
180 REC 90/05	2260	1027	1233	200	56
180 REC 90/06	2455	1152	1303	214	64
180 REC 90/07	2660	1277	1383	230	73
180 REC 90/08	2985	1402	1583	270	81
180 REC 90/09	3110	1527	1583	270	89
180 REC 90/10	3385	1652	1733	300	98
180 REC 90/11	3510	1777	1733	300	106

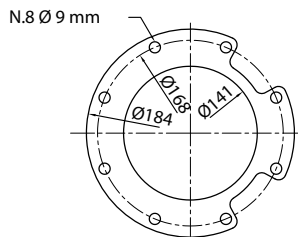

FOR COMMERCIAL TUBE
EXTERNAL DIAMETER: 139,7 mm

n% = Rendimento della pompa
n% = Rendement de la pompe
n% = Pump efficiency
n% = Rendimiento de la bomba

**Max
70%**

kW/st = Assorbimento per stadio
kW/st = Absorption par étage
kW/st = Stage absorption
kW/st = Potencia absorbida por etapa

**Max
10,2**

Tolleranza alla sabbia 50 g/m³ - Sand tolerance 50 g/m³
Tolleranze secondo UNI ISO 9906 livello 3B - Tolerances according to UNI ISO 9906 grade 3B

elevata affidabilità - high reliability

PANELLI®

8"

180 REC90

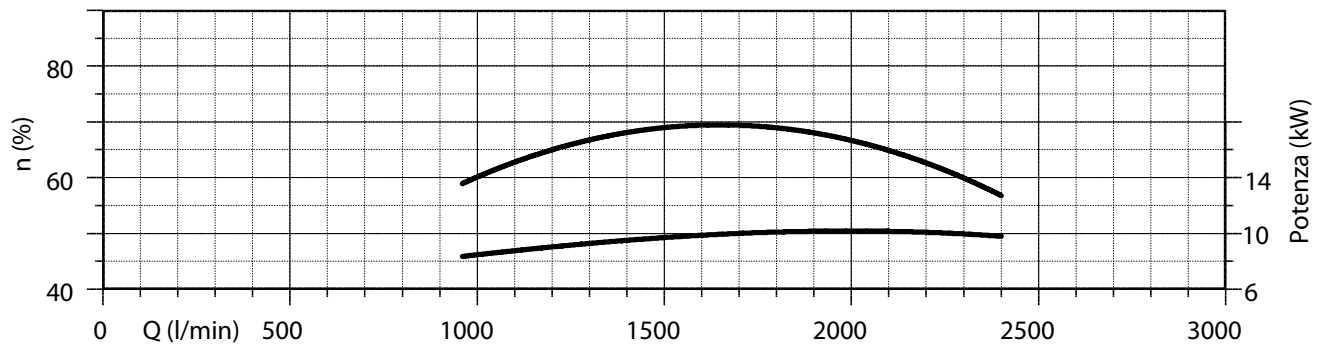
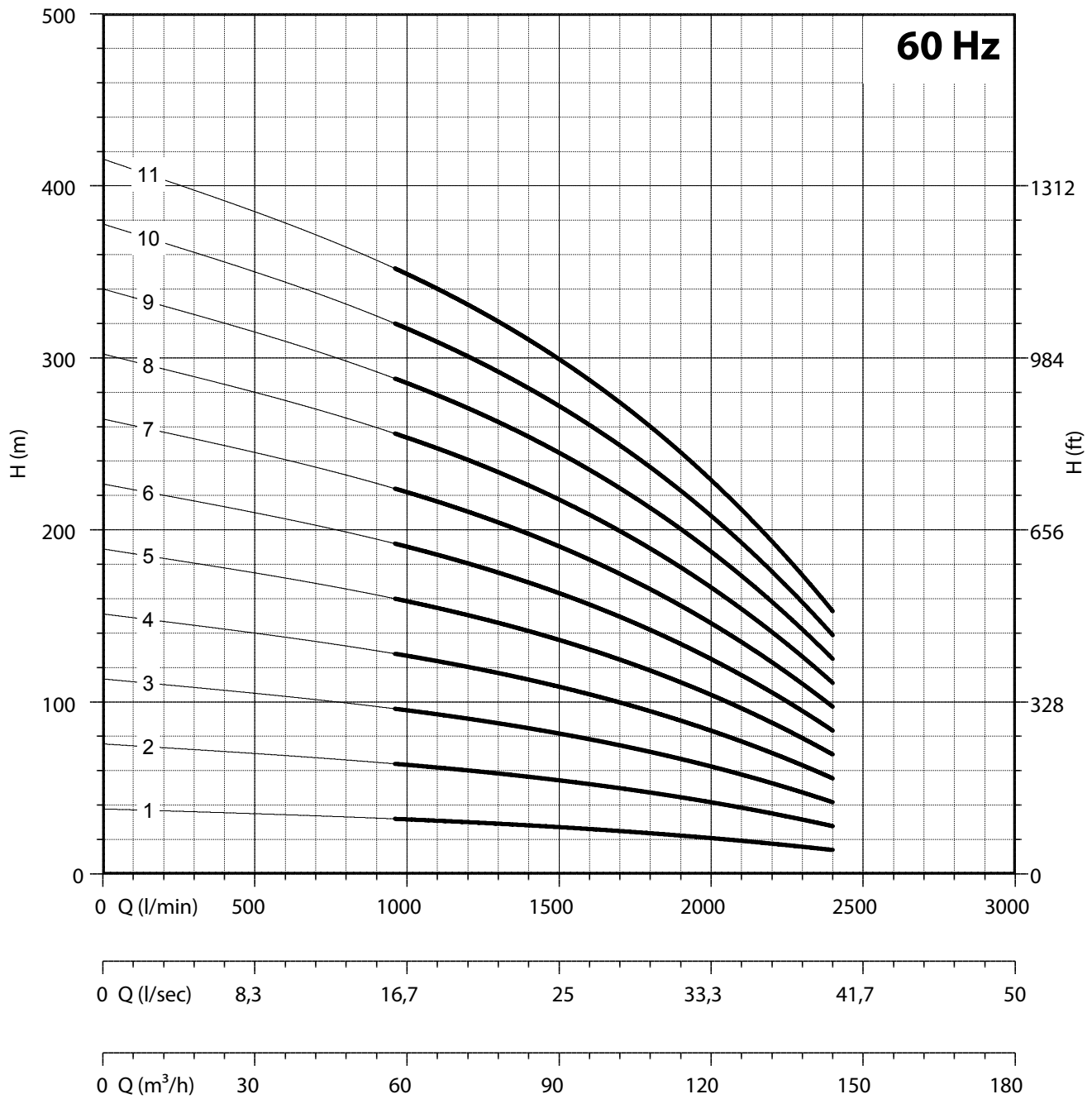

NPSH (m)	25%	50%	75%	100%
180 REC 90	3	4	5	8

elevata affidabilità - high reliability

8"

180 REC102

PANELLI®

CARATTERISTICHE IDRAULICHE - HYDRAULIC PERFORMANCES

Q= Portata - Capacity - Debit **60 Hz n= 3450 min**

Tipo Type	Power		l/min	0	1200	1440	1680	1920	2160	2400	2640	2880
	kW	HP										
			l/sec	0	20	24	28	32	36	40	44	48
			m³/h	0	72	86,4	100,8	115,2	129,6	144	158,4	172,8
180 REC 102/01	13	17,5	H(m)	38	31	30	29	27	26	23	20	16
180 REC 102/02	26	35		76	63	60	58	55	51	46	40	32
180 REC 102/03	37	50		114	94	91	86	82	77	70	60	48
180 REC 102/04	55	75		151	126	121	115	109	102	93	80	64
180 REC 102/05	66	90		189	157	151	144	137	128	116	100	80
180 REC 102/06	75	100		227	189	181	173	164	153	139	120	96
180 REC 102/07	92	125		265	220	212	202	192	179	163	140	112
180 REC 102/08	110	150		303	252	242	230	219	204	186	160	128
180 REC 102/09	110	150		341	283	272	259	246	230	209	180	144

DIMENSIONI D'INGOMBRO E PESI - OVERALL DIMENSIONS AND WEIGHTS

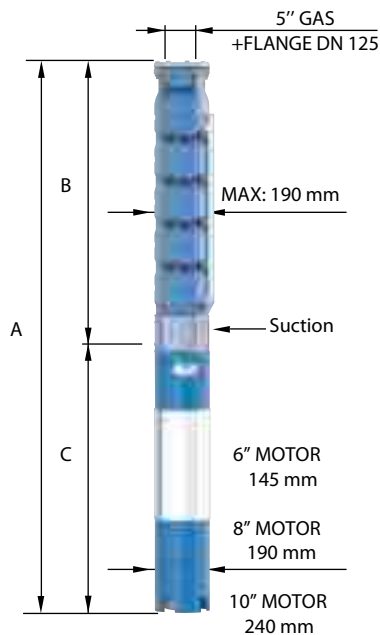

Type	A mm Tri V 460	B mm	C mm Tri	M Kg Tri	P Kg
180 REC 102/01	1368	527	841	70	23
180 REC 102/02	1833	652	1181	100	32
180 REC 102/03	2118	777	1341	118	40
180 REC 102/04	2135	902	1233	200	49
180 REC 102/05	2330	1027	1303	214	58
180 REC 102/06	2535	1152	1383	230	66
180 REC 102/07	2860	1277	1583	270	75
180 REC 102/08	3135	1402	1733	300	83
180 REC 102/09	3260	1527	1733	300	92

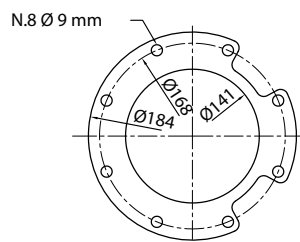

FOR COMMERCIAL TUBE
EXTERNAL DIAMETER: 139,7 mm

n% = Rendimento della pompa
n% = Rendement de la pompe
n% = Pump efficiency
n% = Rendimiento de la bomba

**Max
74%**

kW/st = Assorbimento per stadio
kW/st = Absorption par étage
kW/st = Stage absorption
kW/st = Potencia absorbida por etapa

**Max
12,6**

Tolleranza alla sabbia 50 g/m³ - Sand tolerance 50 g/m³
Tolleranze secondo UNI ISO 9906 livello 3B - Tolerances according to UNI ISO 9906 grade 3B

elevata affidabilità - high reliability

PANELLI®

8"

180 REC102

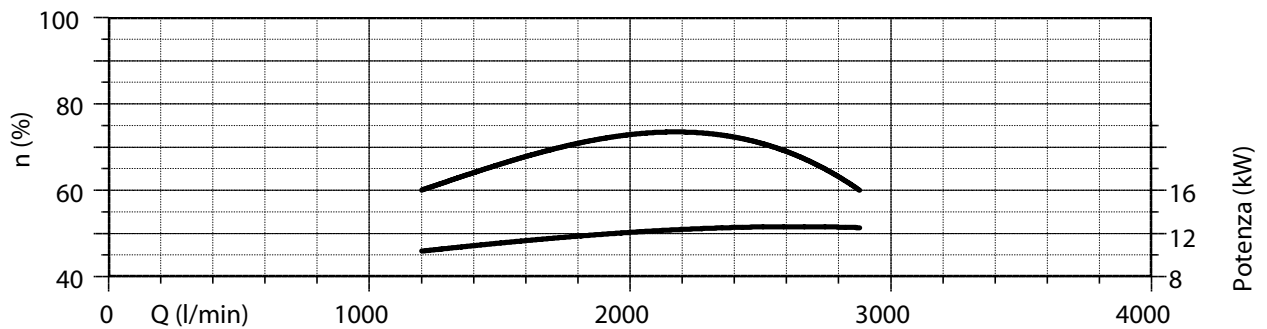
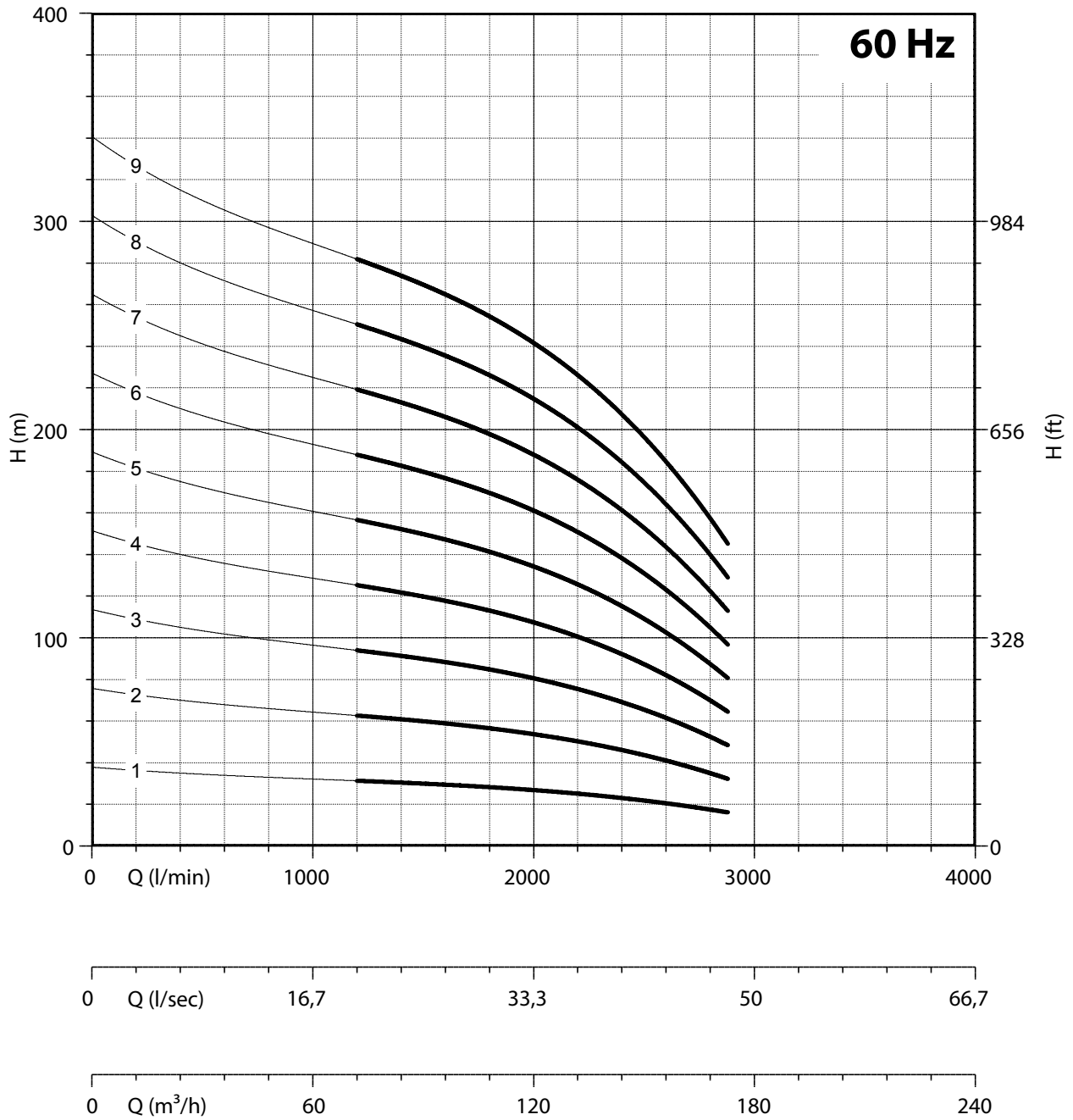

NPSH (m)	25%	50%	75%	100%
180 REC 102	2,5	3,5	4,5	8

elevata affidabilità - high reliability

8"

180 REC124

PANELLI®

CARATTERISTICHE IDRAULICHE - HYDRAULIC PERFORMANCES

Q= Portata - Capacity - Debit

60 Hz n= 3450 min

Tipo Type	Power		H(m)	0	1440	1680	1920	2160	2400	2640	2880	3120	3360	
	kW	HP		l/min	l/sec	m ³ /h	38	76	114	152	190	228	266	304
				0	24	28	32	36	40	44	48	52	56	
180 REC 124/01	13	17,5		0	86	101	115	130	144	158	173	187	202	
180 REC 124/02	26	35		38	86	101	115	130	144	158	173	187	202	
180 REC 124/03	44	60		76	101	115	130	144	158	173	187	202	217	
180 REC 124/04	55	75		114	115	130	144	158	173	187	202	217	232	
180 REC 124/05	66	90		152	130	144	158	173	187	202	217	232	247	
180 REC 124/06	92	125		190	144	158	173	187	202	217	232	247	262	
180 REC 124/07	92	125		228	158	173	187	202	217	232	247	262	277	
180 REC 124/08	110	150		266	173	187	202	217	232	247	262	277	292	

DIMENSIONI D'INGOMBRO E PESI - OVERALL DIMENSIONS AND WEIGHTS

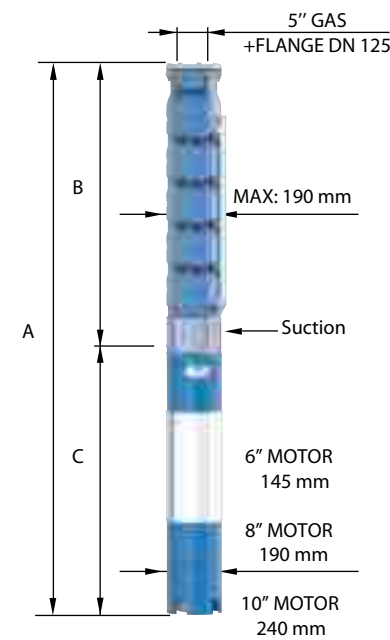

Type	A mm Tri V 460	B mm	C mm Tri	M Kg Tri	P Kg
180 REC 124/01	1368	527	841	70	23
180 REC 124/02	1833	652	1181	100	32
180 REC 124/03	1900	777	1123	178	41
180 REC 124/04	2135	902	1233	200	49
180 REC 124/05	2330	1027	1303	214	58
180 REC 124/06	2735	1152	1583	270	67
180 REC 124/07	2860	1277	1583	270	75
180 REC 124/08	3135	1402	1733	300	84

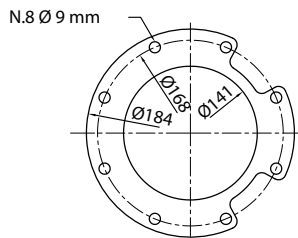

FOR COMMERCIAL TUBE
EXTERNAL DIAMETER: 139,7 mm

n% = Rendimento della pompa
n% = Rendement de la pompe
n% = Pump efficiency
n% = Rendimiento de la bomba

**Max
75%**

kW/st = Assorbimento per stadio
kW/st = Absorption par étage
kW/st = Stage absorption
kW/st = Potencia absorbida por etapa

**Max
13,3**

Tolleranza alla sabbia 50 g/m³ - Sand tolerance 50 g/m³
Tolleranze secondo UNI ISO 9906 livello 3B - Tolerances according to UNI ISO 9906 grade 3B

elevata affidabilità - high reliability

PANELLI®

8"

180 REC124

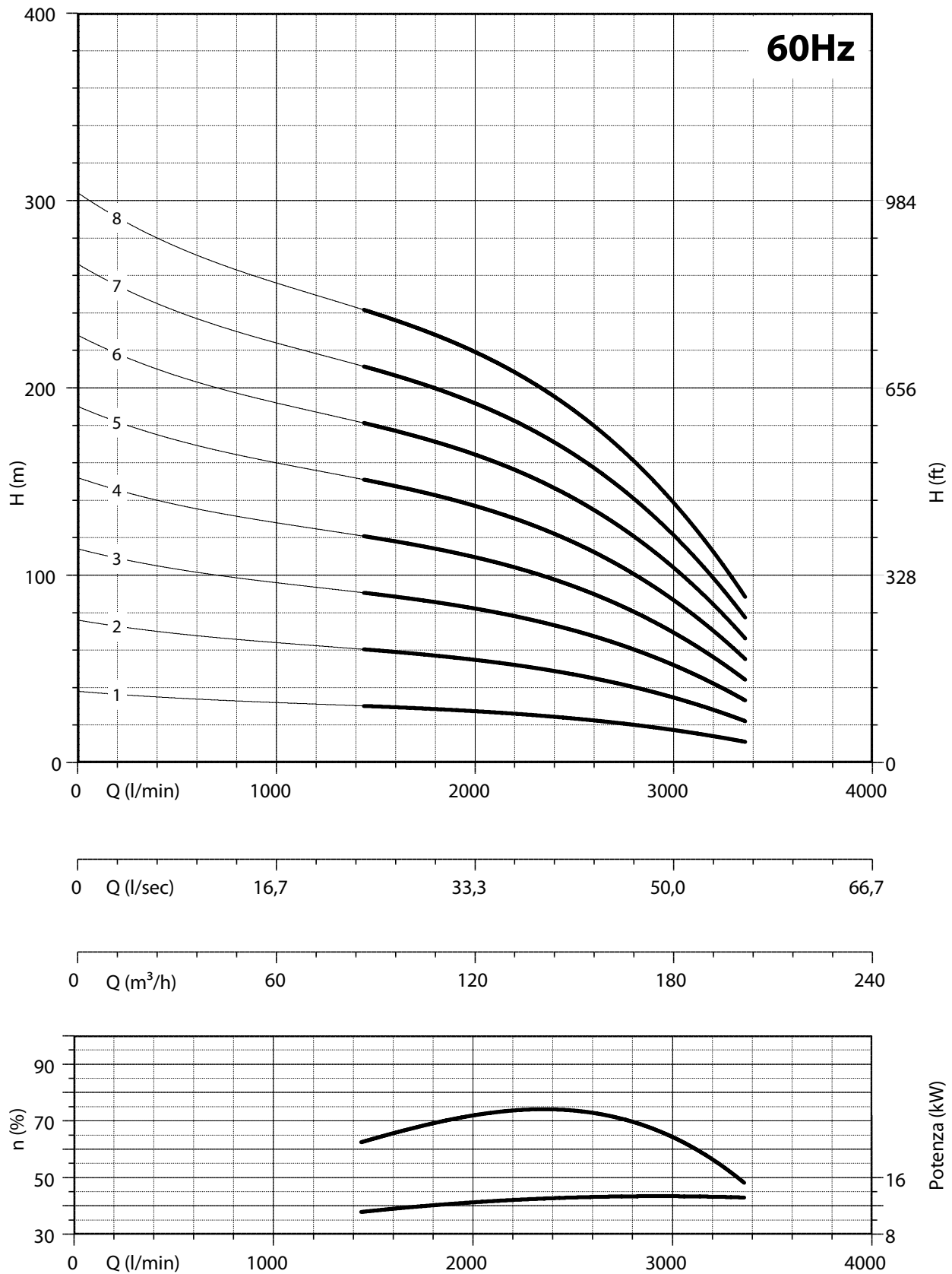

NPSH (m)	25%	50%	75%	100%
180 REC 124	2,5	3	5	9

elevata affidabilità - high reliability

8"

180 REC160

PANELLI®

CARATTERISTICHE IDRAULICHE - HYDRAULIC PERFORMANCES

Q= Portata - Capacity - Debit **60 Hz n= 3450 min**

Tipo Type	Power		l/min l/sec m³/h	0	1920	2160	2400	2640	2880	3120	3360	3600	3840
	kW	HP		0	32	36	40	44	48	52	56	60	64
				0	115,2	129,6	144	158,4	172,8	187,2	201,6	216	230,4
180 REC 160/01	15	20	H(m)	35	27	26	25	24	23	21	19	17	14
180 REC 160/02	30	40		70	55	52	50	47	45	43	39	35	29
180 REC 160/03	44	60		105	82	78	75	71	68	64	58	52	43
180 REC 160/04	66	90		140	109	104	100	95	91	86	77	69	58
180 REC 160/05	75	100		175	137	130	124	118	113	107	97	86	72
180 REC 160/06	92	125		210	164	156	149	142	136	128	116	104	86
180 REC 160/07	110	150		245	192	181	174	166	158	150	135	121	101

DIMENSIONI D'INGOMBRO E PESI - OVERALL DIMENSIONS AND WEIGHTS

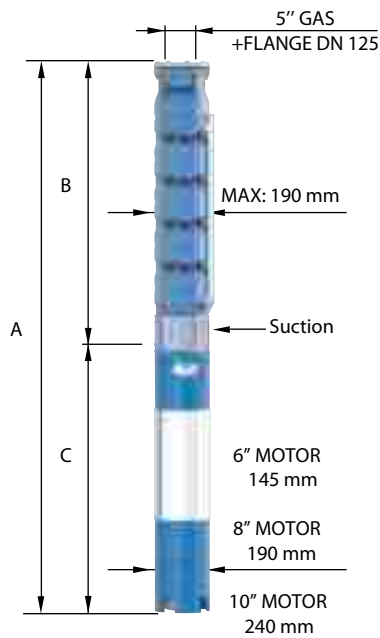

Type	A mm Tri V 460	B mm	C mm Tri	M Kg Tri	P Kg
180 REC 160/01	1483	552	931	75	24
180 REC 160/02	1953	702	1251	108	33
180 REC 160/03	1975	852	1123	178	42
180 REC 160/04	2305	1002	1303	214	51
180 REC 160/05	2535	1152	1383	230	60
180 REC 160/06	2885	1302	1583	270	69
180 REC 160/07	3185	1452	1733	300	78

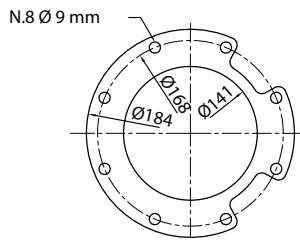

FOR COMMERCIAL TUBE
EXTERNAL DIAMETER: 139,7 mm

n% = Rendimento della pompa
n% = Rendement de la pompe
n% = Pump efficiency
n% = Rendimiento de la bomba

**Max
74%**

kW/st = Assorbimento per stadio
kW/st = Absorption par étage
kW/st = Stage absorption
kW/st = Potencia absorbida por etapa

**Max
14,9**

Tolleranza alla sabbia 50 g/m³ - Sand tolerance 50 g/m³
Tolleranze secondo UNI ISO 9906 livello 3B - Tolerances according to UNI ISO 9906 grade 3B

elevata affidabilità - high reliability

PANELLI®

8"

180 REC160

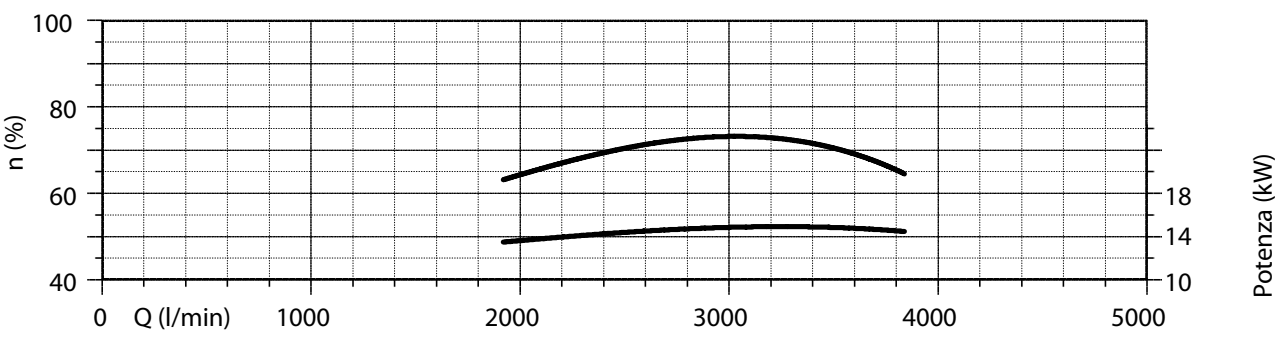
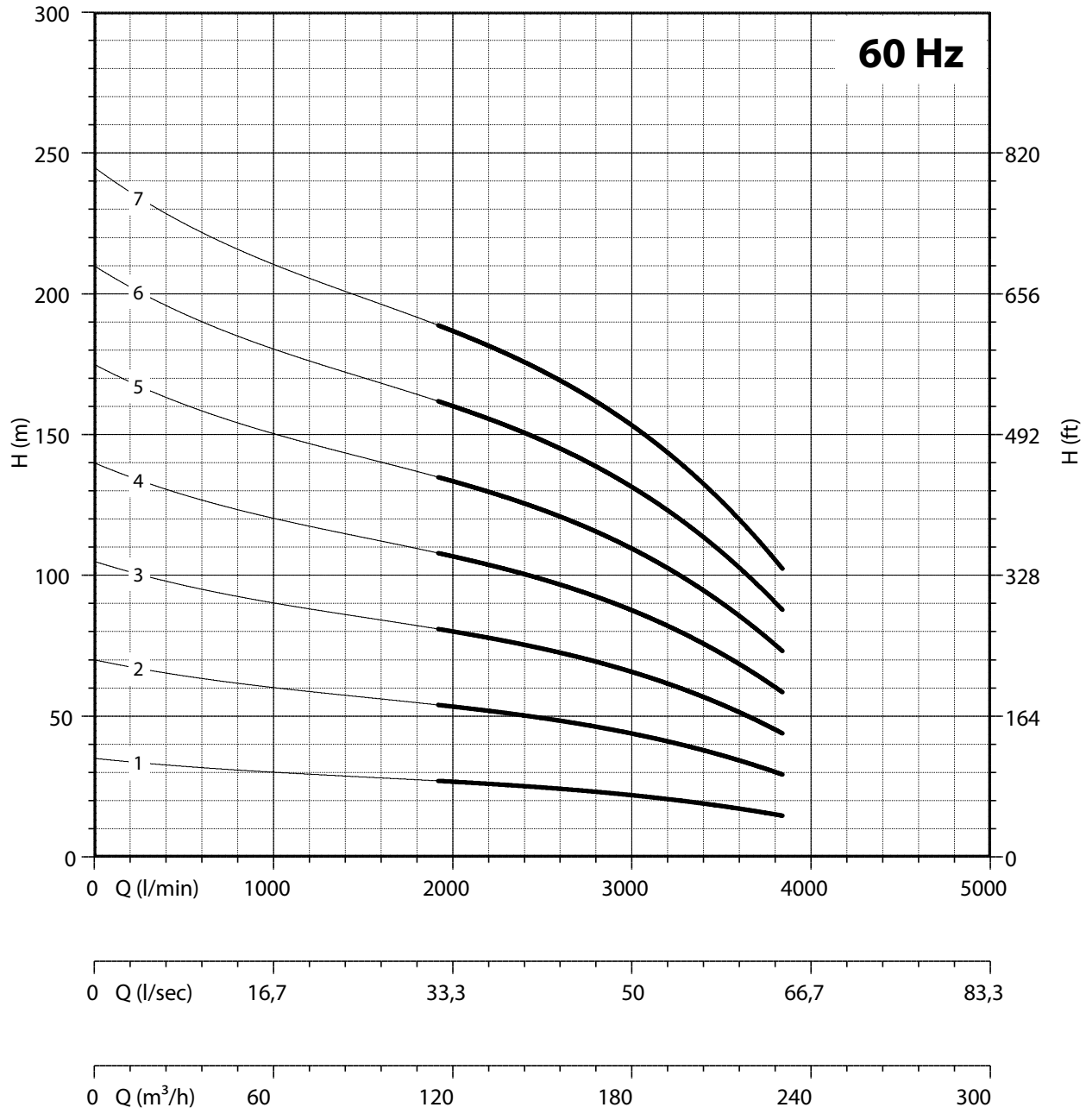

NPSH (m)	25%	50%	75%	100%
180 REC 160	4	4,5	7	13

elevata affidabilità - high reliability

10"

230 REC200



CARATTERISTICHE IDRAULICHE - HYDRAULIC PERFORMANCES

Q= Portata - Capacity - Debit **60 Hz n= 3450 min**

Tipo Type	Power		H(m)	l/min	2160	2640	3120	3600	4080	4560
	kW	HP		l/sec	36	44	52	60	68	76
				m³/h	0	130	158	187	216	245
230 REC 200/1 DR 20	30	40	47	42	40	36	34	29	23	
230 REC 200/1 DR 10	30	40	53	48	45	41	39	32	26	
230 REC 200/1	37	50	60	53	50	46	43	36	29	
230 REC 200/2 DR 20	55	75	93	84	79	73	69	57	46	
230 REC 200/2 DR 10	66	90	105	95	90	82	77	65	51	
230 REC 200/2	66	90	120	107	101	92	86	72	58	
230 REC 200/3 DR 20	92	125	140	126	119	109	103	86	68	
230 REC 200/3 DR 10	92	125	158	143	135	124	116	97	77	
230 REC 200/3	110	150	180	160	151	138	130	108	86	
230 REC 200/4 DR 20	110	150	187	168	159	145	137	114	91	
230 REC 200/4 DR 10	129	175	211	190	180	165	154	129	103	
230 REC 200/4	147	200	240	213	202	184	173	144	115	
230 REC 200/5 DR 20	147	200	233	210	199	181	171	143	114	
230 REC 200/5 DR 10	165	225	264	238	225	206	193	161	128	
230 REC 200/5	165	225	300	266	252	230	216	180	144	
230 REC 200/6 DR 20	165	225	280	252	238	218	206	171	137	
230 REC 200/6 DR 10	185	250	316	285	270	247	232	194	154	
230 REC 200/6	220	300	359	320	302	276	259	216	173	

DIMENSIONI D'INGOMBRO E PESI - OVERALL DIMENSIONS AND WEIGHTS

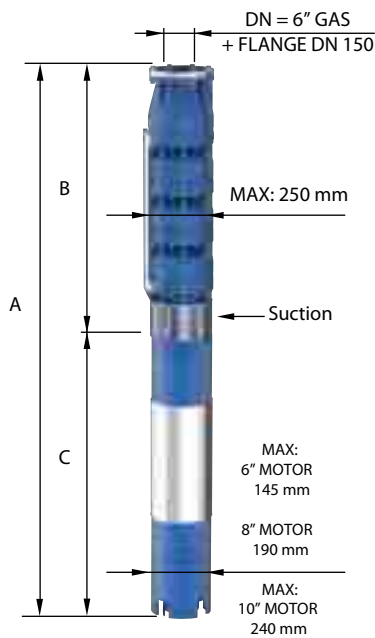

Type	A mm Tri V 460	B mm	C mm Tri	M Kg Tri	P Kg
230 REC 200/1 DR 20	1618	625	993	150	50
230 REC 200/1 DR 10	1618	625	993	150	50
230 REC 200/1	1668	625	1043	160	50
230 REC 200/2 DR 20	2038	805	1233	200	68
230 REC 200/2 DR 10	2108	805	1303	214	68
230 REC 200/2	2108	805	1303	214	68
230 REC 200/3 DR 20	2568	985	1583	270	87
230 REC 200/3 DR 10	2568	985	1583	270	87
230 REC 200/3	2718	985	1733	300	87
230 REC 200/4 DR 20	2898	1165	1733	300	105
230 REC 200/4 DR 10	2799	1165	1634	385	105
230 REC 200/4	2899	1165	1734	415	105
230 REC 200/5 DR 20	3079	1345	1734	415	124
230 REC 200/5 DR 10	3199	1345	1854	444	124
230 REC 200/5	3199	1345	1854	444	124
230 REC 200/6 DR 20	3379	1525	1854	444	142
230 REC 200/6 DR 10	3509	1525	1984	480	142
230 REC 200/6	0	1525	0	0	142

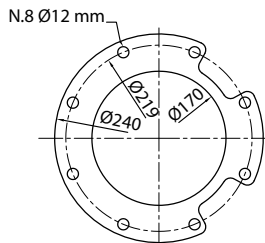

FOR COMMERCIAL TUBE
EXTERNAL DIAMETER: 168,3 mm

n% = Rendimento della pompa
n% = Rendement de la pompe
n% = Pump efficiency
n% = Rendimiento de la bomba

kW/st = Assorbimento per stadio
kW/st = Absorption par étage
kW/st = Stage absorption
kW/st = Potencia absorbida por etapa

Max
75,5%

DR 10
Max 75%

DR 20
Max 74%

Max
33,6

DR 10
Max 30,3

DR 20
Max 27,2

Tolleranza alla sabbia 50 g/m³ - Sand tolerance 50 g/m³
Tolleranze secondo UNI ISO 9906 livello 3B - Tolerances according to UNI ISO 9906 grade 3B

elevata affidabilità - high reliability



10"
230 REC200

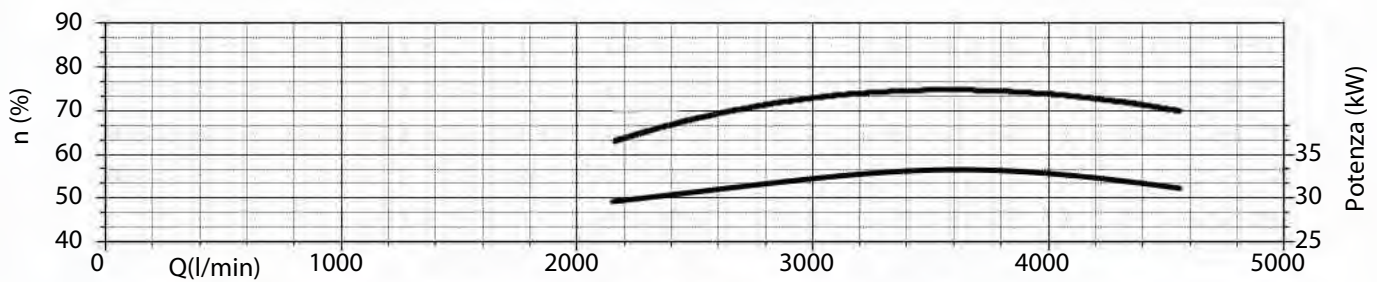
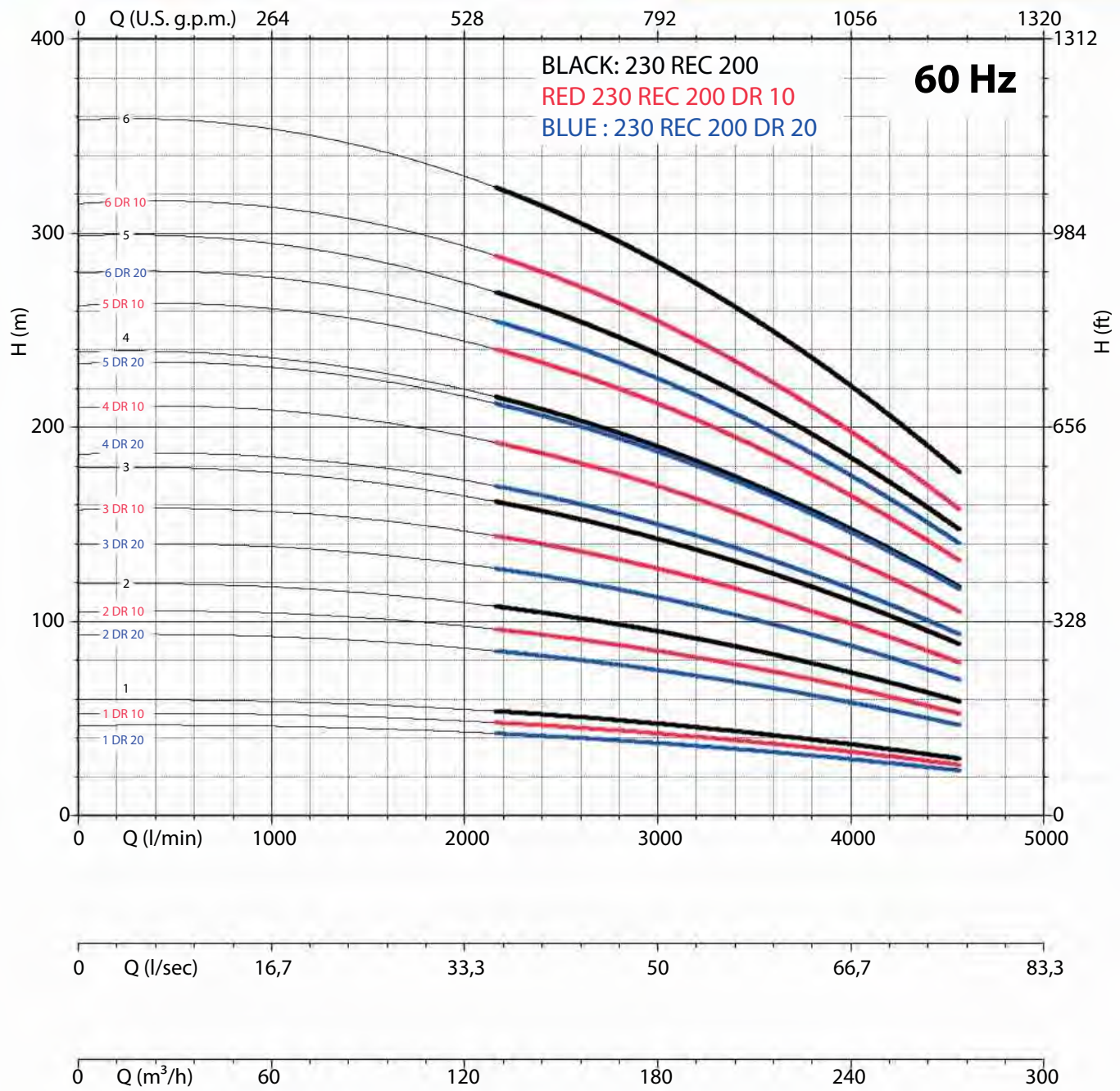

NPSH (m)	25%	50%	75%	100%
230 REC 200	3,6	5,3	8,1	14

elevata affidabilità - high reliability

10"

230 REC220



CARATTERISTICHE IDRAULICHE - HYDRAULIC PERFORMANCES

Q= Portata - Capacity - Debit **60 Hz n= 3450 min**

Tipo Type	Power		l/min	0	2640	3120	3600	4080	4560	5040	5280
	kW	HP									
			l/sec	0	44	52	60	68	76	84	88
			m ³ /h	0	158,4	187,2	216	244,8	273,5	302,3	316,7
230 REC 220/1 DR 20	37	50	H(m)	49	42	40	37	34	32	27	24
230 REC 220/1 DR 10	37	50		55	48	45	42	39	36	31	25
230 REC 220/1	44	60		62	53	50	48	43	40	35	32
230 REC 220/2 DR 20	66	90		98	84	79	75	69	64	55	47
230 REC 220/2 DR 10	75	100		111	95	90	85	77	72	62	50
230 REC 220/2	92	125		124	107	101	95	86	81	69	63
230 REC 220/3 DR 20	92	125		147	126	119	112	103	96	82	71
230 REC 220/3 DR 10	110	150		166	143	135	127	116	108	92	75
230 REC 220/3	129	175		186	160	151	143	130	121	104	95
230 REC 220/4 DR 20	129	175		196	168	159	150	137	128	109	94
230 REC 220/4 DR 10	147	200		221	190	180	169	154	144	123	100
230 REC 220/4	165	225		248	213	202	190	173	161	138	127
230 REC 220/5 DR 20	165	225		245	210	199	187	171	160	137	118
230 REC 220/5 DR 10	185	250		276	238	225	212	193	180	154	125
230 REC 220/5	220	300		310	266	252	238	216	202	173	158
230 REC 220/6 DR 20	220	300		294	252	238	225	206	192	164	142
230 REC 220/6 DR 10	220	300		332	285	270	254	232	216	185	150
230 REC 220/6	250	340		372	320	302	285	259	242	207	190

DIMENSIONI D'INGOMBRO E PESI - OVERALL DIMENSIONS AND WEIGHTS

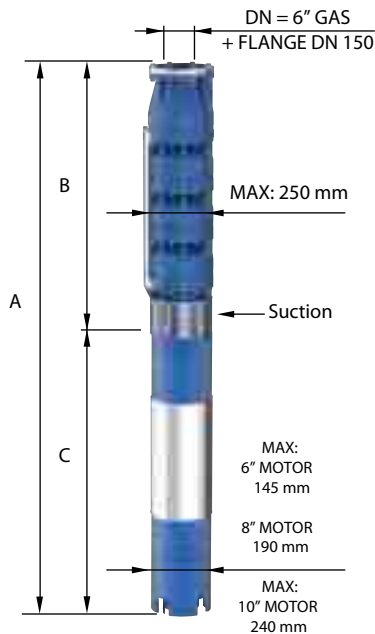

Type	A mm Tri V 460	B mm	C mm Tri	M Kg Tri	P Kg
230 REC 220/1 DR 20	1668	625	1043	160	50
230 REC 220/1 DR 10	1668	625	1043	160	50
230 REC 220/1	1748	625	1123	178	50
230 REC 220/2 DR 20	2108	805	1303	214	68
230 REC 220/2 DR 10	2188	805	1383	230	68
230 REC 220/2	2388	805	1583	270	68
230 REC 220/3 DR 20	2568	985	1583	270	87
230 REC 220/3 DR 10	2718	985	1733	300	87
230 REC 220/3	2619	985	1634	385	87
230 REC 220/4 DR 20	2799	1165	1634	385	105
230 REC 220/4 DR 10	2899	1165	1734	415	105
230 REC 220/4	3019	1165	1854	444	105
230 REC 220/5 DR 20	3199	1345	1854	444	124
230 REC 220/5 DR 10	3329	1345	1984	480	124
230 REC 220/5	-	1345	-	-	124
230 REC 220/6 DR 20	-	1525	-	-	142
230 REC 220/6 DR 10	-	1525	-	-	142
230 REC 220/6	-	1525	-	-	142

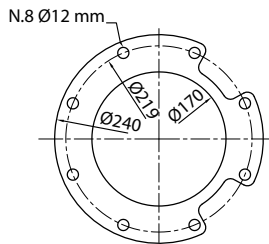

FOR COMMERCIAL TUBE
EXTERNAL DIAMETER: 168,3 mm

n% = Rendimento della pompa
n% = Rendement de la pompe
n% = Pump efficiency
n% = Rendimiento de la bomba

Max
76,5%

DR 10
Max 76%

DR 20
Max 75,5%

kW/st = Assorbimento per stadio
kW/st = Absorption par étage
kW/st = Stage absorption
kW/st = Potencia absorbida por etapa

Max
39,8

DR 10
Max 35,5

DR 20
Max 31,7

Tolleranza alla sabbia 50 g/m³ - Sand tolerance 50 g/m³
Tolleranze secondo UNI ISO 9906 livello 3B - Tolerances according to UNI ISO 9906 grade 3B

elevata affidabilità - high reliability



10"
230 REC220

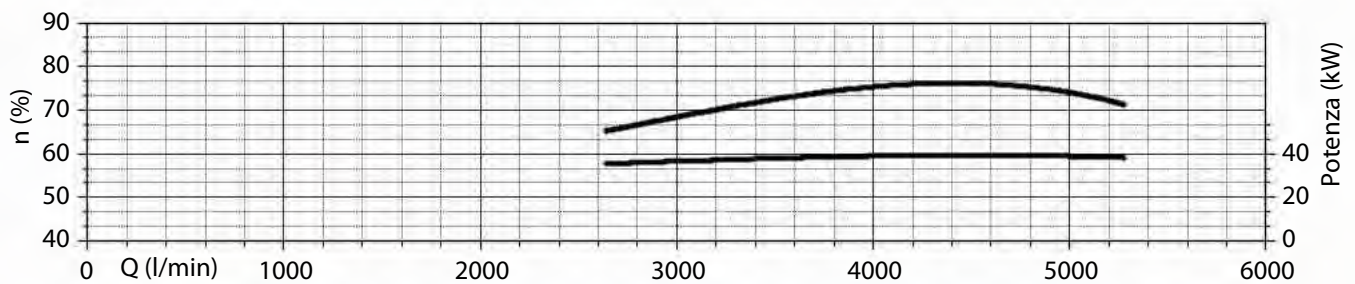
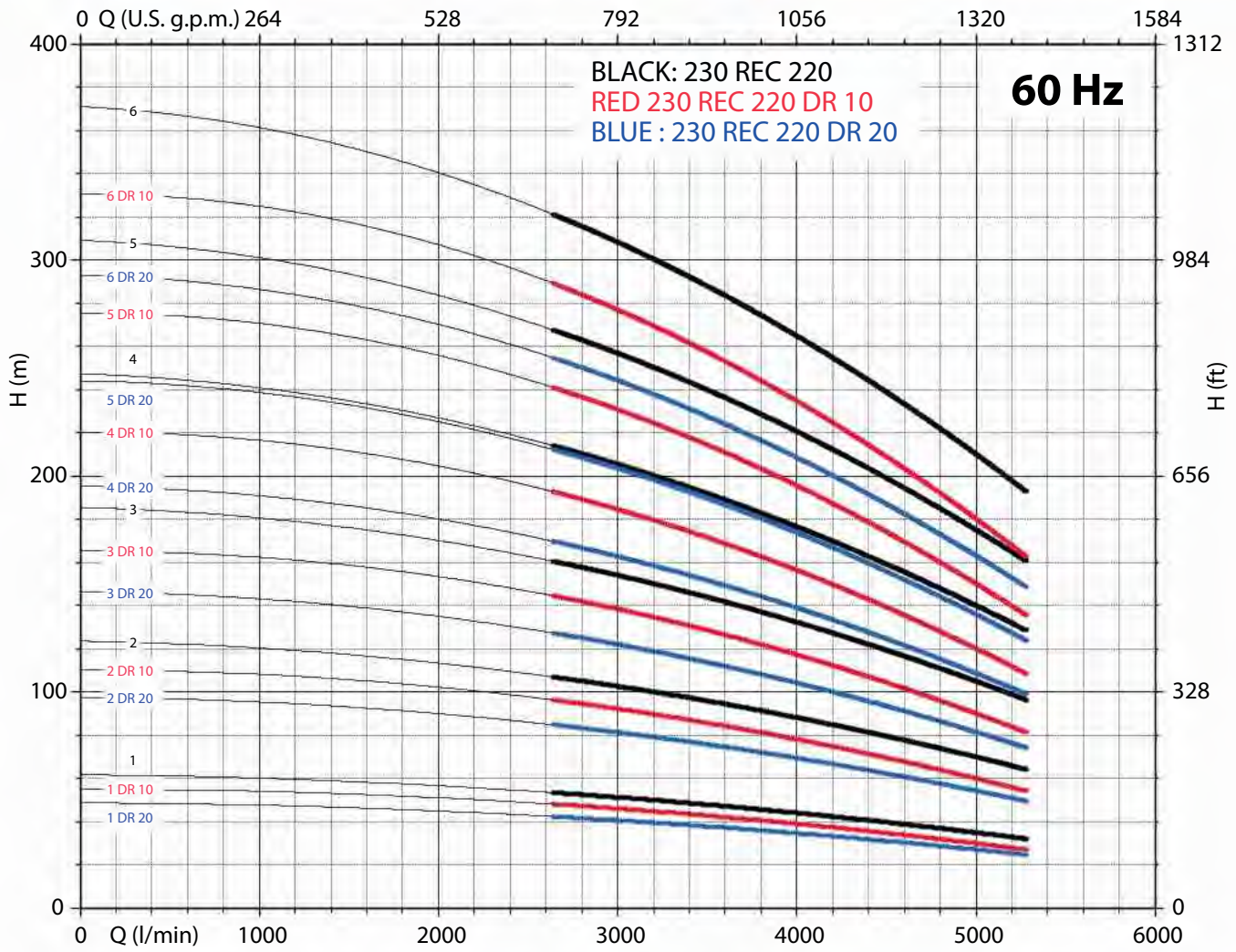

NPSH (m)	25%	50%	75%	100%
230 REC 220	3,7	5,4	8,3	14,2

elevata affidabilità - high reliability

10"

230 REC240



CARATTERISTICHE IDRAULICHE - HYDRAULIC PERFORMANCES

Q= Portata - Capacity - Debit **60 Hz n= 3450 min**

Tipo Type	Power		l/min l/sec m³/h	0	2880	3360	3840	4320	4800	5280	5760	6000
	kW	HP		0	48	56	64	72	80	88	96	100
				0	172,8	201,6	230,4	259,1	287,9	316,7	345,5	359,9
230 REC 240/1 DR 20	37	50	H(m)	49	41	39	38	35	32	30	26	25
230 REC 240/1 DR 10	44	60		55	46	44	42	40	36	33	29	28
230 REC 240/1	44	60		62	52	49	48	45	40	37	33	32
230 REC 240/2 DR 20	75	100		98	82	78	75	71	64	59	52	50
230 REC 240/2 DR 10	92	125		111	92	88	85	79	72	67	59	56
230 REC 240/2	92	125		124	104	98	95	89	81	75	66	63
230 REC 240/3 DR 20	110	150		147	123	117	113	106	96	89	79	75
230 REC 240/3 DR 10	129	175		166	138	131	127	119	108	100	88	85
230 REC 240/3	147	200		186	156	147	143	134	121	112	99	95
230 REC 240/4 DR 20	165	225		196	164	156	151	142	128	119	105	100
230 REC 240/4 DR 10	165	225		221	184	175	169	159	144	134	118	113
230 REC 240/4	185	250		248	207	196	190	179	161	150	132	127
230 REC 240/5 DR 20	220	300		245	204	194	189	177	160	148	131	125
230 REC 240/5 DR 10	220	300		276	230	219	212	199	180	167	147	141
230 REC 240/5	250	340		310	259	245	238	223	202	187	166	158
230 REC 240/6 DR 20	250	340		294	245	233	226	213	192	178	157	150
230 REC 240/6 DR 10	250	340		332	276	263	254	238	216	200	176	169
230 REC 240/6	300	400		372	311	294	285	268	242	225	199	190

DIMENSIONI D'INGOMBRO E PESI - OVERALL DIMENSIONS AND WEIGHTS

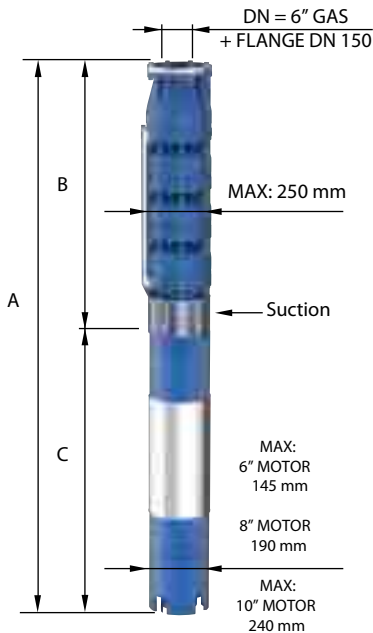

Type	A mm Tri V 460	B mm	C mm Tri	M Kg Tri	P Kg
230 REC 240/1 DR 20	1668	625	1043	160	50
230 REC 240/1 DR 10	1748	625	1123	178	50
230 REC 240/1	1748	625	1123	178	50
230 REC 240/2 DR 20	2188	805	1383	230	68
230 REC 240/2 DR 10	2388	805	1583	270	68
230 REC 240/2	2388	805	1583	270	68
230 REC 240/3 DR 20	2718	985	1733	300	87
230 REC 240/3 DR 10	2619	985	1634	385	87
230 REC 240/3	2719	985	1734	415	87
230 REC 240/4 DR 20	3019	1165	1854	444	105
230 REC 240/4 DR 10	3019	1165	1854	444	105
230 REC 240/4	3149	1165	1984	480	105
230 REC 240/5 DR 20	0	1345	0	0	124
230 REC 240/5 DR 10	0	1345	0	0	124
230 REC 240/5	0	1345	0	0	124
230 REC 240/6 DR 20	0	1525	0	0	142
230 REC 240/6 DR 10	0	1525	0	0	142
230 REC 240/6	0	1525	0	0	142

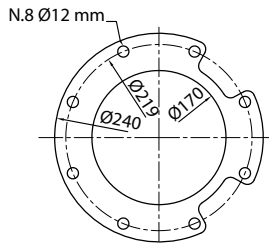

FOR COMMERCIAL TUBE
EXTERNAL DIAMETER: 168,3 mm

n% = Rendimento della pompa
n% = Rendement de la pompe
n% = Pump efficiency
n% = Rendimiento de la bomba

Max 76,5%

DR 10 Max 76%

DR 20 Max 75,5%

kW/st = Assorbimento per stadio
kW/st = Absorption par étage
kW/st = Stage absorption
kW/st = Potencia absorbida por etapa

Max 45,5

DR 10 Max 40,7

DR 20 Max 37,9

Tolleranza alla sabbia 50 g/m³ - Sand tolerance 50 g/m³
Tolleranze secondo UNI ISO 9906 livello 3B - Tolerances according to UNI ISO 9906 grade 3B

elevata affidabilità - high reliability



10" 230 REC240

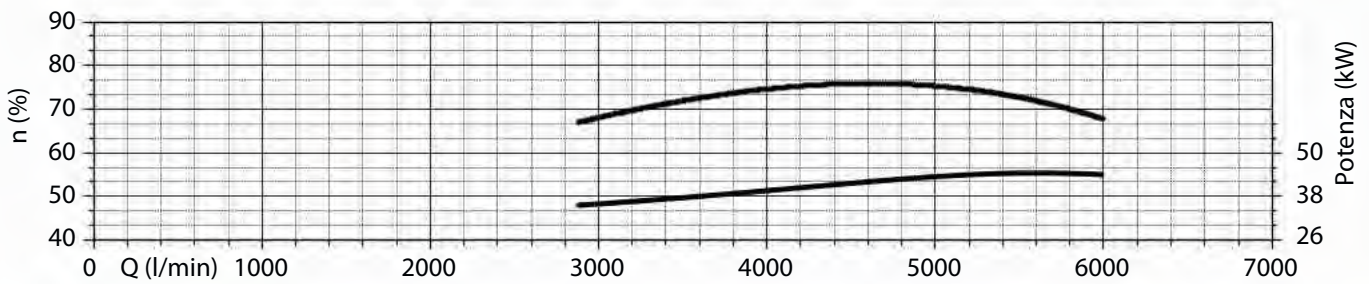
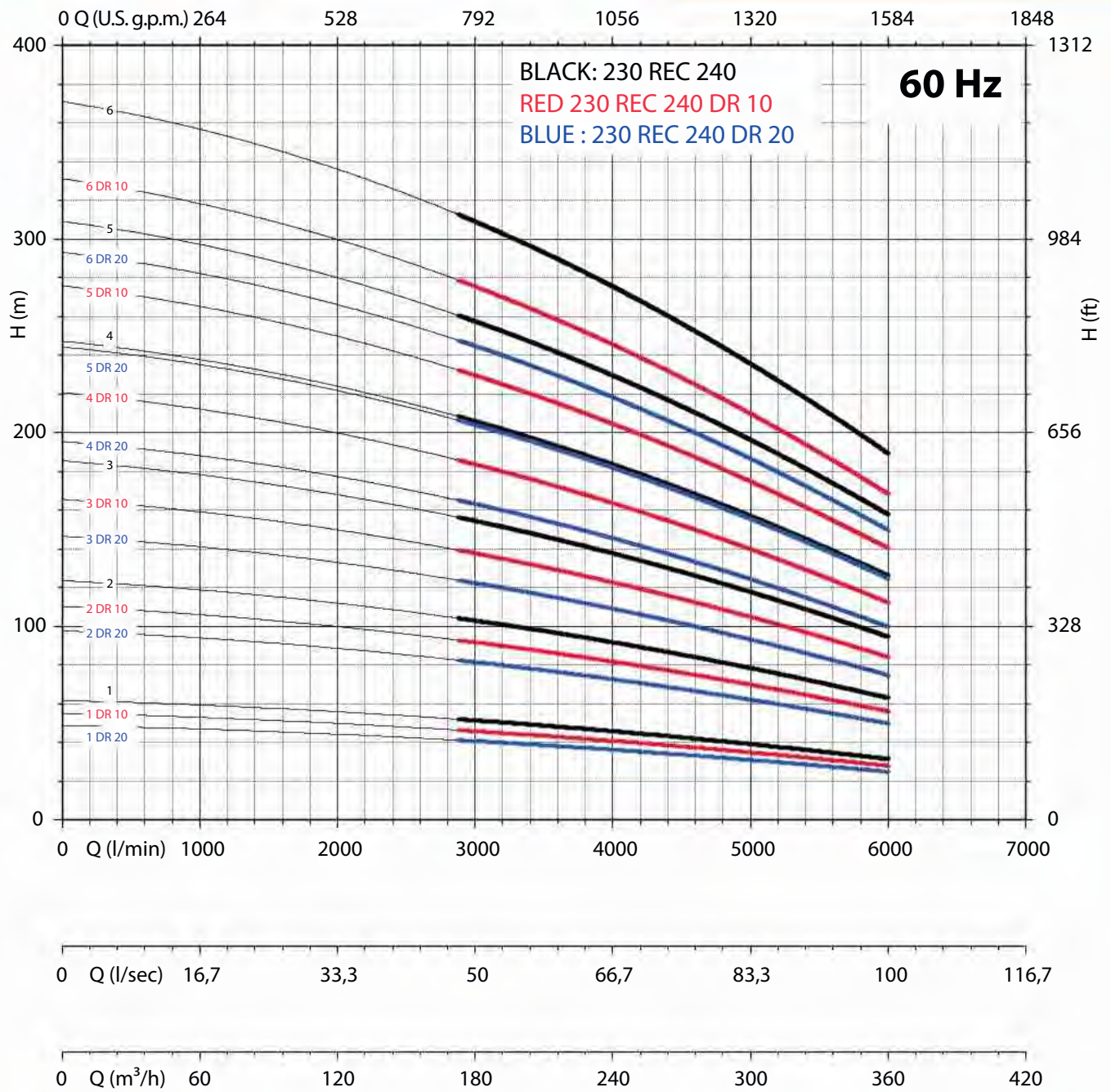

NPSH (m)	25%	50%	75%	100%
230 REC 240	3,9	5,5	8,5	14,4

elevata affidabilità - high reliability

PANELLI®

italian excellence since 1906

10"

230 REC | 60Hz

POMPA SOMMERSA SEMIASSIALE - GHISA SEMIAXIAL SUBMERSIBLE PUMP - CAST IRON

POMPA 10" ACCOPPIATA A MOTORE 6" 10" PUMP COUPLING WITH 6" MOTORS CONNECTION FLANGE

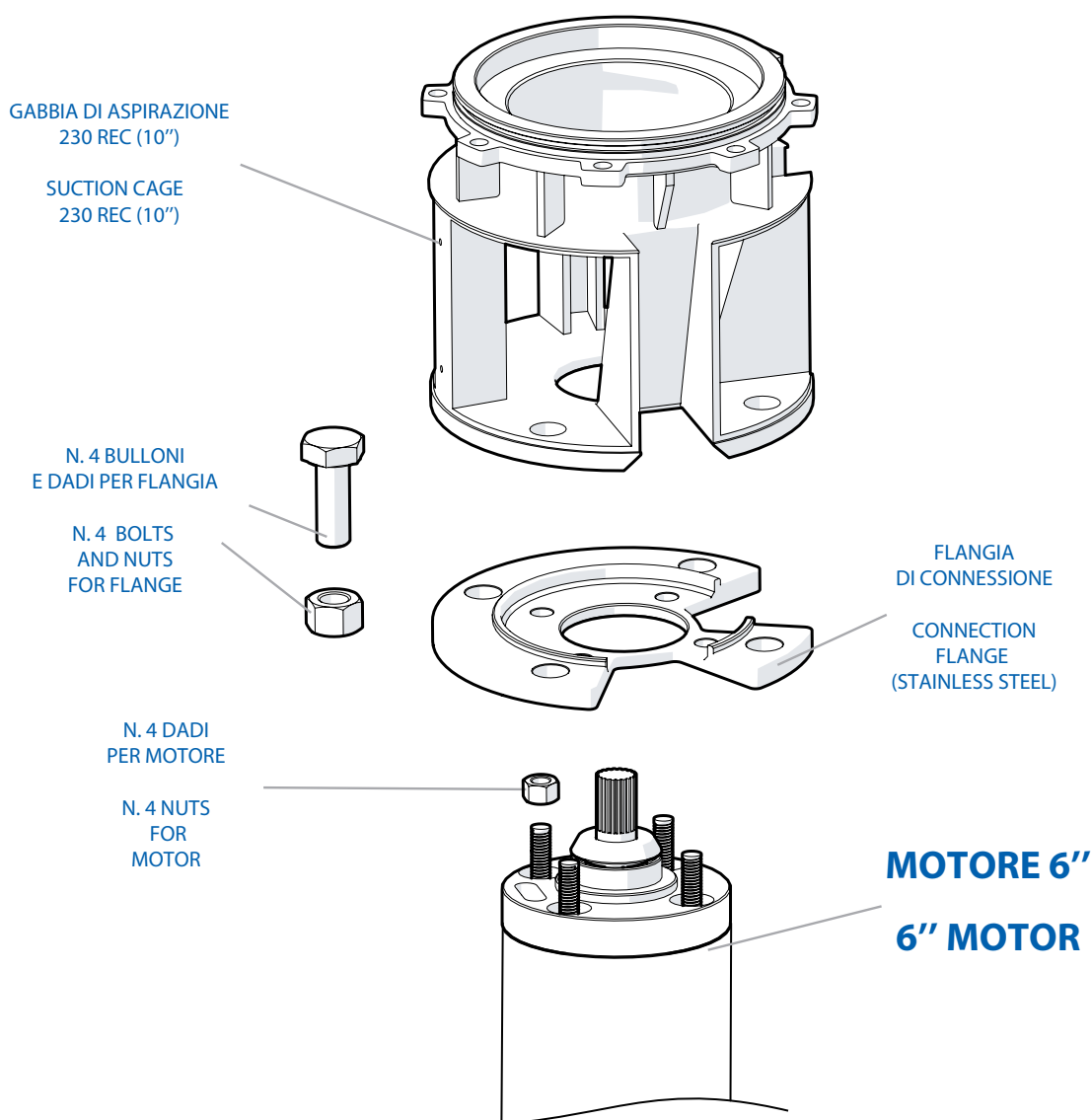

6" - 8" - 10" REC - 30



italian excellence since 1906

6" 8" 10" 140 REC
180 REC | **60Hz**
230 REC

POMPA SOMMERSA SEMIASSIALE - GHISA
SEMIAXIAL SUBMERSIBLE PUMP - CAST IRON

RICAMBI
TABELLE MATERIALI

SPARE PARTS
MATERIAL CHARTS

6" 8" 10"

140 - 180 - 230 REC

PANELLI®

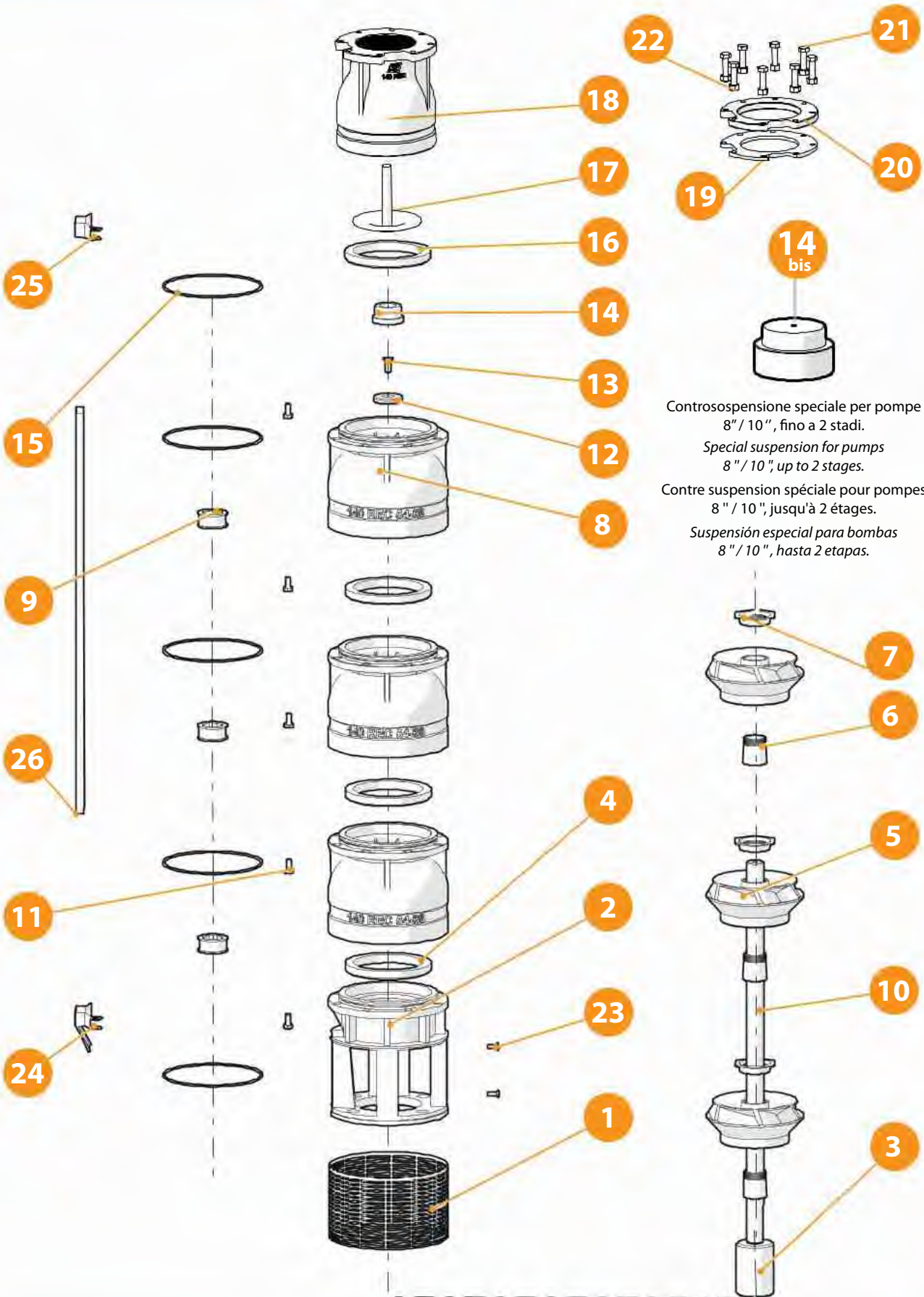

Controsospensione speciale per pompe 8" / 10", fino a 2 stadi.

Special suspension for pumps 8" / 10", up to 2 stages.

Contre suspension spéciale pour pompes 8" / 10", jusqu'à 2 étages.

Suspensión especial para bombas 8" / 10", hasta 2 etapas.

140 - 180 - 230 REC

N. CODE	DESCRIZIONE (italiano)	MATERIALE (italiano)	DESCRIZIONE (english)	MATERIAL (english)
1	SUCCHERUOLA	ACCIAIO INOX AISI 304	SUCTION STRAINER	AISI 304
2	GABBIA DI ASPIRAZIONE	GHISA	SUCTION CAGE	CAST IRON
3	GIUNTO	ACCIAIO INOX AISI 304	JOINT	AISI 304
4	ANELLO USURA	GOMMA	USURY RING	NBR
5	GIRANTE	GHISA	IMPELLER	CAST IRON
6	CONO	ACCIAIO INOX AISI 304	CONE	AISI 304
7	GHIERA	ACCIAIO INOX AISI 304	HEXAGONAL RING	AISI 304
8	DIFFUSORE	GHISA	DIFFUSEUR	CAST IRON
9	BRONZINA	GOMMA	BEARING BUSH	NBR
10	ALBERO POMPA	ACCIAIO INOX AISI 304	PUMP SHAFT	AISI 304
11	N. 8 VITI PER DIFFUSORE	ACCIAIO INOX AISI 304	N.8 SCREW FOR DIFFUSEUR	AISI 304
12	DISCO ACCIAIO	ACCIAIO INOX AISI 304	RING	AISI 304
13	VITE DISCO ACCIAIO	ACCIAIO INOX AISI 304	SCREW FOR DISK	AISI 304
14	CONTROSOSPENSIONE	PTFE + 25 CARBONE	COUNTERTHRUST	PTFE + 25 CARBON
15	O-RING	GOMMA	O-RING	NBR
16	GUARNIZIONE FARFALLA	GOMMA	GASKET VALVE	NBR
17	FARFALLA	ACCIAIO INOX AISI 304	CAP VALVE	AISI 304
18	CORPO VALVOLA	GHISA	BODY VALVE	CAST IRON
19	UARNIZIONE CONTROFLANGIA	GOMMA	SEAL COUNTERFLANGE	NBR
20	CONTROFLANGIA	FERRO	COUNTERFLANGE	IRON
21	N. 8 VITI PER CONTROFLANGIA	ACCIAIO INOX AISI 304	N. 8 SCREWS FOR COUNTERFLANGE	AISI 304
22	N. 8 DADI PER CONTROFLANGIA	ACCIAIO INOX AISI 304	N.8 NUT FOR COUNTERFLANGE	AISI 304
23	N. 2 VITI PER SUCCHERUOLA	ACCIAIO INOX AISI 304	N. 2 SCREWS FOR SUCTION STRAINER	AISI 304
24	STAFFETTA INFERIORE	ACCIAIO INOX AISI 304	LOWER FLANGE	AISI 304
25	STAFFETTA SUPERIORE	ACCIAIO INOX AISI 304	UPPER FLANGE	AISI 304
26	COPRICAPO	ACCIAIO INOX AISI 304	COVER CABLE	AISI 304

N. CODE	DESCRIPTION (Français)	MATÉRIEL (Français)	DESCRIPCIÓN (español)	MATERIAL (español)
1	CREPINE	ACIER INOXYDABLE AISI 304	REJILLA	ACERO INOXIDABLE AISI 304
2	CAGE D'ASPIRATION	FONTE	CUERPO DE ASPIRACION	HIERRO FUNDIDO
3	JOINT	ACIER INOXYDABLE AISI 304	ACOPLAMIENTO	ACERO INOXIDABLE AISI 304
4	BAGUE D'USURE	CAOUTCHOUC	ANILLO DE DESGASTE	GOMA
5	ROUE	FONTE	IMPULSOR	HIERRO FUNDIDO
6	CONE	ACIER INOXYDABLE AISI 304	CONO	ACERO INOXIDABLE AISI 304
7	BAGUE	ACIER INOXYDABLE AISI 304	ANILLO HEXAGONAL	ACERO INOXIDABLE AISI 304
8	DIFFUSEUR	FONTE	DIFUSOR	HIERRO FUNDIDO
9	COUSSINET	CAOUTCHOUC	COJINETE	GOMA
10	ABRE POMPE	ACIER INOXYDABLE AISI 304	EJE DE BOMBA	ACERO INOXIDABLE AISI 304
11	N. 8 VIS POUR DIFFUSEUR	ACIER INOXYDABLE AISI 304	N. 8 TORNILLOS DIFUSOR	ACERO INOXIDABLE AISI 304
12	RING	ACIER INOXYDABLE AISI 304	ANILLO EN ACERO	ACERO INOXIDABLE AISI 304
13	VIS RING	ACIER INOXYDABLE AISI 304	TORNILLO POR ANILLO EN ACERO	ACERO INOXIDABLE AISI 304
14	CONTRESUSPENSION	PTFE + 25% GRAPHITE	CONTRA-SUSPENSION	PTFE + 25% GRAPHITE
15	O-RING	CAOUTCHOUC	ANILLO TORICO	GOMA
16	GASKET VALVE	CAOUTCHOUC	JUNTA DE VALVULA	GOMA
17	PLAT	ACIER INOXYDABLE AISI 304	VALVULA	ACERO INOXIDABLE AISI 304
18	CORPS DE VALVE	FONTE	CUERPO DE IMPULSION	HIERRO FUNDIDO
19	JOINT ETANCHEITE CONTREBRIDE	CAOUTCHOUC	JUNTA CONTRE-BRIDA	GOMA
20	CONTREBRIDE	FER	CONTRE-BRIDA	HIERRO
21	N. 8 VIS POUR CONTREBRIDE	ACIER INOXYDABLE AISI 304	N. 8 TORNILLOS CONTRE-BRIDA	ACERO INOXIDABLE AISI 304
22	N. 8 ECROU POUR CONTREBRIDE	ACIER INOXYDABLE AISI 304	N. 8 TUERCAS CONTRE-BRIDA	ACERO INOXIDABLE AISI 304
23	N. 2 VIS POUR CREPINE	ACIER INOXYDABLE AISI 304	N. 2 TORNILLOS REJILLA	ACERO INOXIDABLE AISI 304
24	BRIDE INFERIEURE	ACIER INOXYDABLE AISI 304	GRAPA INFERIOR	ACERO INOXIDABLE AISI 304
25	BRIDE SUPERIEURE	ACIER INOXYDABLE AISI 304	GRAPA SUPERIOR	ACERO INOXIDABLE AISI 304
26	PROTECTOR CABLE	ACIER INOXYDABLE AISI 304	PARACABLE	ACERO INOXIDABLE AISI 304

14 BIS

CONTROSOSPENSIONE SPECIALE PER POMPE 8" / 10"; FINO A 2 STADI

SPECIAL SUSPENSION FOR PUMPS 8" / 10"; UP TO 2 STAGES

CONTRE SUSPENSION SPÉCIALE POUR POMPES 8" / 10"; JUSQU'À 2 ÉTAGES

SUSPENSIÓN ESPECIAL PARA BOMBAS 8" / 10"; HASTA 2 ETAPAS

PTFE +25 CARBONE

PTFE + 25 CARBON

PTFE + 25% GRAPHITE

PTFE + 25% GRAPHITE

elevata affidabilità - high reliability

6" 8" 10"

140 - 180 - 230 REC

PANELLI®

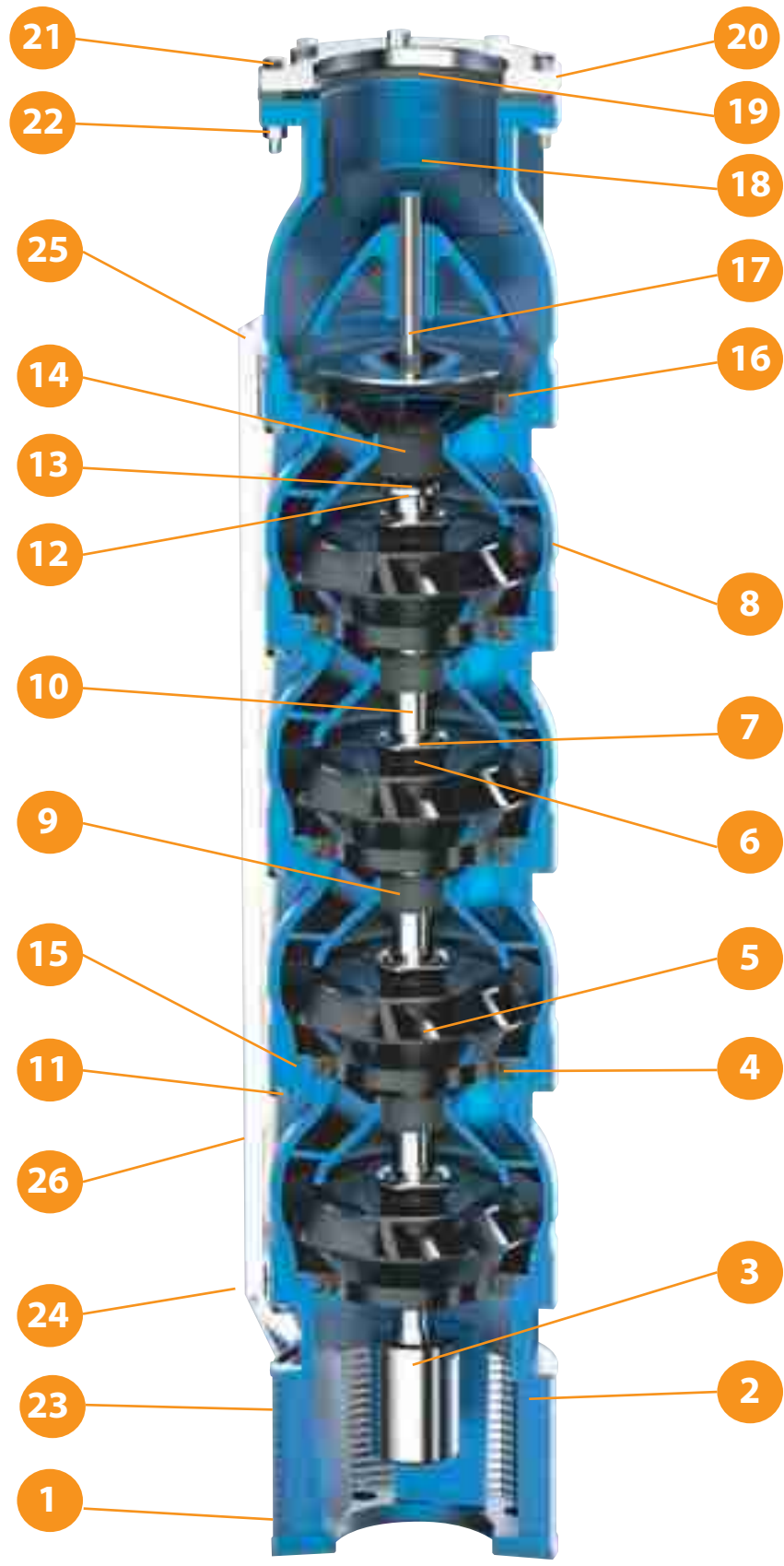

14 bis
Controsospensione speciale per pompe
8" / 10", fino a 2 stadi.
*Special suspension for pumps
8" / 10", up to 2 stages.*
Contre suspension spéciale pour pompes
8" / 10", jusqu'à 2 étages.
*Suspensión especial para bombas
8" / 10", hasta 2 etapas.*

140 - 180 - 230 REC

N. CODE	DESCRIZIONE (italiano)	MATERIALE (italiano)	DESCRIZIONE (english)	MATERIAL (english)
1	SUCCHERUOLA	ACCIAIO INOX AISI 304	SUCTION STRAINER	AISI 304
2	GABBIA DI ASPIRAZIONE	GHISA	SUCTION CAGE	CAST IRON
3	GIUNTO	ACCIAIO INOX AISI 304	JOINT	AISI 304
4	ANELLO USURA	GOMMA	USURY RING	NBR
5	GIRANTE	GHISA	IMPELLER	CAST IRON
6	CONO	ACCIAIO INOX AISI 304	CONE	AISI 304
7	GHIERA	ACCIAIO INOX AISI 304	HEXAGONAL RING	AISI 304
8	DIFFUSORE	GHISA	DIFFUSEUR	CAST IRON
9	BRONZINA	GOMMA	BEARING BUSH	NBR
10	ALBERO POMPA	ACCIAIO INOX AISI 304	PUMP SHAFT	AISI 304
11	N. 8 VITI PER DIFFUSORE	ACCIAIO INOX AISI 304	N.8 SCREW FOR DIFFUSEUR	AISI 304
12	DISCO ACCIAIO	ACCIAIO INOX AISI 304	RING	AISI 304
13	VITE DISCO ACCIAIO	ACCIAIO INOX AISI 304	SCREW FOR DISK	AISI 304
14	CONTROSOSPENSIONE	PTFE + 25 CARBONE	COUNTERTHRUST	PTFE + 25 CARBON
15	O-RING	GOMMA	O-RING	NBR
16	GUARNIZIONE FARFALLA	GOMMA	GASKET VALVE	NBR
17	FARFALLA	ACCIAIO INOX AISI 304	CAP VALVE	AISI 304
18	CORPO VALVOLA	GHISA	BODY VALVE	CAST IRON
19	UARNIZIONE CONTROFLANGIA	GOMMA	SEAL COUNTERFLANGE	NBR
20	CONTROFLANGIA	FERRO	COUNTERFLANGE	IRON
21	N. 8 VITI PER CONTROFLANGIA	ACCIAIO INOX AISI 304	N. 8 SCREWS FOR COUNTERFLANGE	AISI 304
22	N. 8 DADI PER CONTROFLANGIA	ACCIAIO INOX AISI 304	N.8 NUT FOR COUNTERFLANGE	AISI 304
23	N. 2 VITI PER SUCCHERUOLA	ACCIAIO INOX AISI 304	N. 2 SCREWS FOR SUCTION STRAINER	AISI 304
24	STAFFETTA INFERIORE	ACCIAIO INOX AISI 304	LOWER FLANGE	AISI 304
25	STAFFETTA SUPERIORE	ACCIAIO INOX AISI 304	UPPER FLANGE	AISI 304
26	COPRICAPO	ACCIAIO INOX AISI 304	COVER CABLE	AISI 304

N. CODE	DESCRIPTION (Français)	MATÉRIEL (Français)	DESCRIPCIÓN (español)	MATERIAL (español)
1	CREPINE	ACIER INOXYDABLE AISI 304	REJILLA	ACERO INOXIDABLE AISI 304
2	CAGE D'ASPIRATION	FONTE	CUERPO DE ASPIRACION	HIERRO FUNDIDO
3	JOINT	ACIER INOXYDABLE AISI 304	ACOPLAMIENTO	ACERO INOXIDABLE AISI 304
4	BAGUE D'USURE	CAOUTCHOUC	ANILLO DE DESGASTE	GOMA
5	ROUE	FONTE	IMPULSOR	HIERRO FUNDIDO
6	CONE	ACIER INOXYDABLE AISI 304	CONO	ACERO INOXIDABLE AISI 304
7	BAGUE	ACIER INOXYDABLE AISI 304	ANILLO HEXAGONAL	ACERO INOXIDABLE AISI 304
8	DIFFUSEUR	FONTE	DIFUSOR	HIERRO FUNDIDO
9	COUSSINET	CAOUTCHOUC	COJINETE	GOMA
10	ABRE POMPE	ACIER INOXYDABLE AISI 304	EJE DE BOMBA	ACERO INOXIDABLE AISI 304
11	N. 8 VIS POUR DIFFUSEUR	ACIER INOXYDABLE AISI 304	N. 8 TORNILLOS DIFUSOR	ACERO INOXIDABLE AISI 304
12	RING	ACIER INOXYDABLE AISI 304	ANILLO EN ACERO	ACERO INOXIDABLE AISI 304
13	VIS RING	ACIER INOXYDABLE AISI 304	TORNILLO POR ANILLO EN ACERO	ACERO INOXIDABLE AISI 304
14	CONTRESUSPENSION	PTFE + 25% GRAPHITE	CONTRA-SUSPENSION	PTFE + 25% GRAPHITE
15	O-RING	CAOUTCHOUC	ANILLO TORICO	GOMA
16	GASKET VALVE	CAOUTCHOUC	JUNTA DE VALVULA	GOMA
17	PLAT	ACIER INOXYDABLE AISI 304	VALVULA	ACERO INOXIDABLE AISI 304
18	CORPS DE VALVE	FONTE	CUERPO DE IMPULSION	HIERRO FUNDIDO
19	JOINT ETANCHEITE CONTREBRIDE	CAOUTCHOUC	JUNTA CONTRE-BRIDA	GOMA
20	CONTREBRIDE	FER	CONTRE-BRIDA	HIERRO
21	N. 8 VIS POUR CONTREBRIDE	ACIER INOXYDABLE AISI 304	N. 8 TORNILLOS CONTRE-BRIDA	ACERO INOXIDABLE AISI 304
22	N. 8 ECROU POUR CONTREBRIDE	ACIER INOXYDABLE AISI 304	N. 8 TUERCAS CONTRE-BRIDA	ACERO INOXIDABLE AISI 304
23	N. 2 VIS POUR CREPINE	ACIER INOXYDABLE AISI 304	N. 2 TORNILLOS REJILLA	ACERO INOXIDABLE AISI 304
24	BRIDE INFERIEURE	ACIER INOXYDABLE AISI 304	GRAPA INFERIOR	ACERO INOXIDABLE AISI 304
25	BRIDE SUPERIEURE	ACIER INOXYDABLE AISI 304	GRAPA SUPERIOR	ACERO INOXIDABLE AISI 304
26	PROTECTOR CABLE	ACIER INOXYDABLE AISI 304	PARACABLE	ACERO INOXIDABLE AISI 304

14 BIS

CONTROSOSPENSIONE SPECIALE PER POMPE 8" / 10"; FINO A 2 STADI

SPECIAL SUSPENSION FOR PUMPS 8" / 10"; UP TO 2 STAGES

CONTRE SUSPENSION SPÉCIALE POUR POMPES 8" / 10"; JUSQU'À 2 ÉTAGES

SUSPENSIÓN ESPECIAL PARA BOMBAS 8" / 10"; HASTA 2 ETAPAS

PTFE + 25 CARBONE

PTFE + 25 CARBON

PTFE + 25% GRAPHITE

PTFE + 25% GRAPHITE

PANELLI®

italian excellence since 1906



Panelli s.r.l.

Sede legale: 37047 San Bonifacio (VR) ITALY - Via E. Fermi, 7

Unità produttiva: 15122 (Alessandria) ITALY

Via Rana , 63/65 – Z.I D5 - Spinetta Marengo

Phone : + 39 0131 619506 - Fax : + 39 0131 619017

Email : info@panellipumps.it - www.panellipumps.it

Società soggetta a direzione e coordinamento di

PEDROLLO GROUP s.r.l.

